

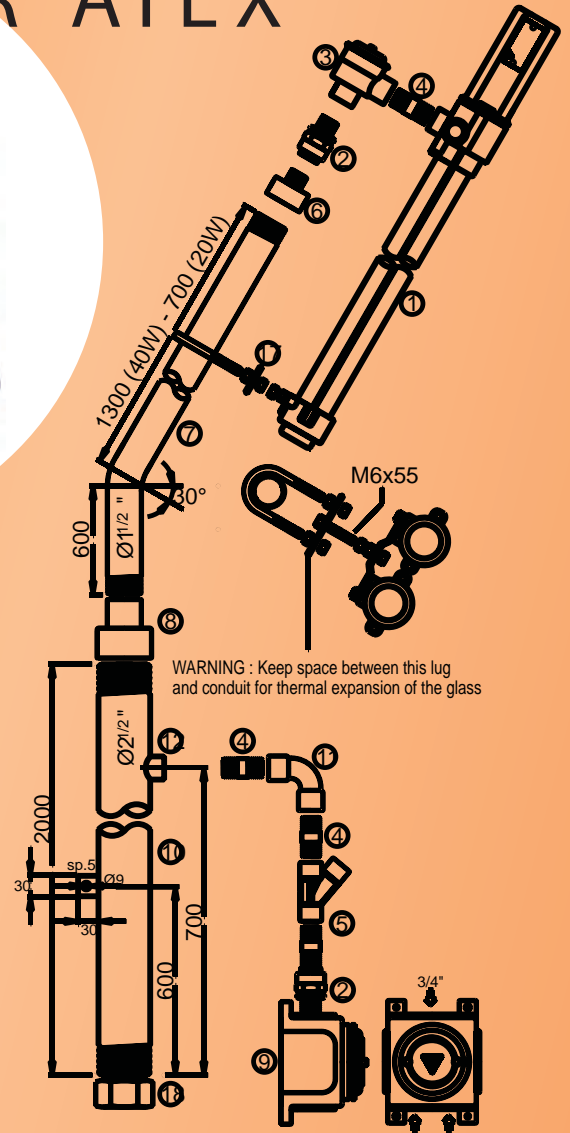

Co.Si.Me

EQUIPMENT FOR ATEX

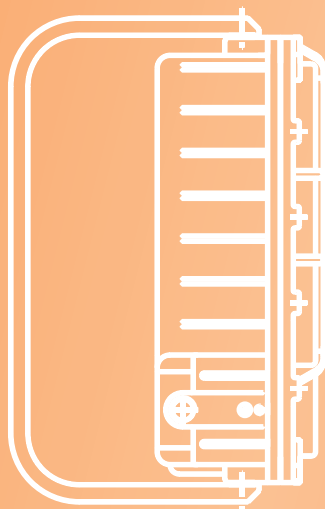
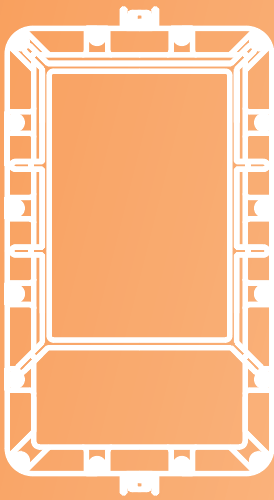
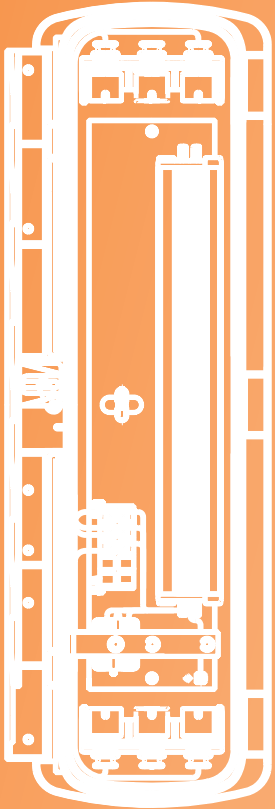
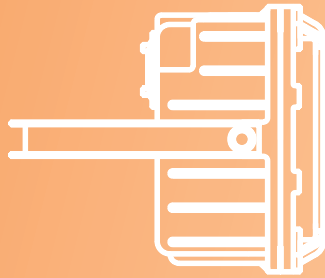
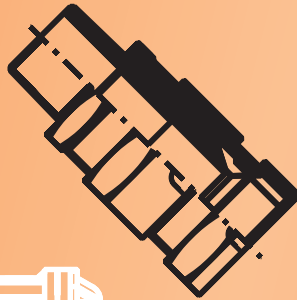
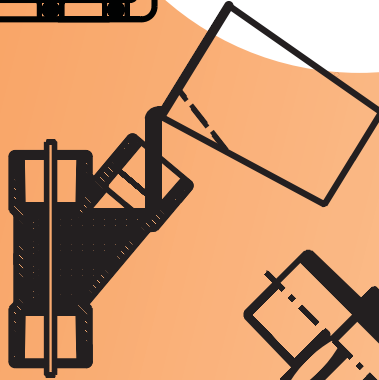
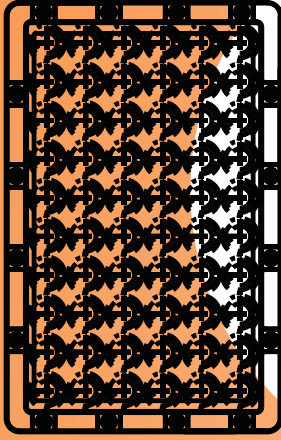
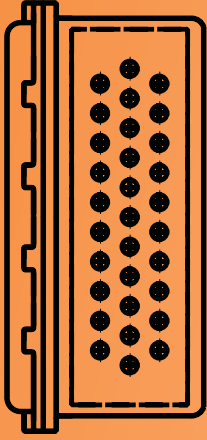

www.cosime.com

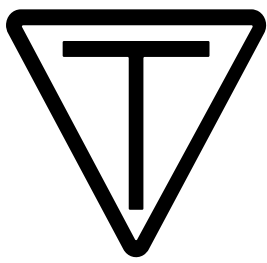

CO.SIME.

EQUIPMENT FOR ATEX



	GAS	II2G Ex d IIC /Ex e II	IP66	Zone 1 - Zone 21 - Zone 2 - Zone 22	
	DUST	II2D Ex tD A21	IP66	❄️-20°C ÷ ☀️+40°C	❄️-50°C ÷ ☀️+80°C

Materiale : Acciaio zincato
 Materiale : Lega leggera (L), ottone (D), acciaio inox
 a richiesta AISI 304 (Y), AISI 316 (YS)
 Guarnizioni : EPDM
 Guarnizioni : Silicone
 a richiesta

Material : Galvanized steel
 Material : light alloy (L), brass (D), stainless steel
 on request inox AISI 304 (Y), AISI 316 (YS)
 Gaskets : EPDM
 Gaskets : Silicon
 on request



	Tappi Plugs			
	Poliammide Polyamide	Acciaio Zincato Galvanized steel	Ottone Brass	Acciaio inox Stainless steel
x1.5	Codice Code	Codice Code	Codice Code	Codice Code
M12	PLG M12P	-	PLG 12MD	PLG 12MY
M16	PLG M16P	-	PLG 16MD	PLG 16MY
M20	PLG M20P	PLG 1M	PLG 1MD	PLG 1MY
M25	PLG M25P	PLG 1M	PLG 2MD	PLG 2MY
M32	PLG M32P	PLG 1M	PLG 3MD	PLG 3MY
M40	PLG M40P	PLG 1M	PLG 4MD	PLG 4MY
M50	PLG M50P	PLG 1M	PLG 5MD	PLG 5MY
M63	PLG M63P	PLG 1M	PLG 6MD	PLG 6MY

	Dadi Nuts			Guarnizione Gasket
	Poliammide Polyamide	Ottone Brass	Acciaio inox Stainless s.	Gomma EPDM EPDM rubber
	Codice Code	Codice Code	Codice Code	Codice Code
DL M12P	DL 12MD	DL 12MY	G 12	
DL M16P	DL 16MD	DL 16MY	G 16	
DL M20P	DL 1MD	DL 1MY	G 1	
DL M25P	DL 2MD	DL 2MY	G 2	
DL M32P	DL 3MD	DL 3MY	G 3	
DL M40P	DL 4MD	DL 4MY	G 4	
DL M50P	DL 5MD	DL 5MY	G 5	
DL M63P.	DL 6MD	DL 6MY	G 6	

Ø Gk	Tappi Plugs		
	Acciaio Zincato Galvanized steel	Ottone Brass	Acciaio inox Stainless steel
¼	PLG 28	PLG 28D	-
	PLG 38	PLG 38D	-
½	PLG 1	PLG 1D	PLG 1Y
¾	PLG 2	PLG 2D	PLG 2Y
1	PLG 3	PLG 3D	PLG 3Y
1¼	PLG 4	PLG 4D	-
1½	PLG 5	PLG 5D	PLG 5Y
2	PLG 6	PLG 6D	PLG 6Y
2½	PLG 7	PLG 7D	-
3	PLG 8	PLG 8D	-

	Dadi Nuts			Guarnizione Gasket
	Acciaio Zn Galvan. steel	Ottone Brass	Acciaio inox Stainless	Gomma EPDM EPDM rubber
	Codice Code	Codice Code	Codice Code	Codice Code
DL 28	DL 28D	-	G 28	
DL 38	DL 38D	-	G 38	
DL 1	DL 1D	DL 1Y	G 1	
DL 2	DL 2D	DL 2Y	G 2	
DL 3	DL 3D	DL 3Y	G 3	
DL 4	DL 4D	-	G 4	
DL 5	DL 5D	DL 5Y	G 5	
DL 6	DL 6D	DL 6Y	G 6	
DL 7	DL 7D	-	G 7	
DL 8	DL 8D	-	G 8	

Ø NPT	Tappi Plugs		
	Acciaio Zincato Galvanized steel	Ottone Brass	Acciaio inox Stainless steel
½	PLG 1N	PLG 1ND	PLG 1NY
¾	PLG 2N	PLG 2ND	PLG 2NY
1	PLG 3N	PLG 3ND	PLG 3NY
1¼	PLG 4N	PLG 4ND	-
1½	PLG 5N	PLG 5ND	PLG 5NY
2	PLG 6N	PLG 6ND	PLG 6NY
2½	PLG 7N	PLG 7ND	-
3	PLG 8N	PLG 8ND	-

	Dadi Nuts			Guarnizione Gasket
	Acciaio Zn Galvan. steel	Ottone Brass	Acciaio inox Stainless	Gomma EPDM EPDM rubber
	Codice Code	Codice Code	Codice Code	Codice Code
DL 1N	DL 1ND	DL 1NY	G 1	
DL 2N	DL 2ND	DL 2NY	G 2	
DL 3N	DL 3ND	DL 3NY	G 3	
DL 4N	DL 4ND	-	G 4	
DL 5N	DL 5ND	DL 5NY	G 5	
DL 6N	DL 6ND	DL 6NY	G 6	
DL 7N	DL 7ND	-	G 7	
DL 8N	DL 8ND	-	G 8	

Filettatura conica : protezione IP 66
 utilizzare sigillante Loctite 577
 Taper thread : protection IP 66
 use compound Loctite 577





GAS	II2G Ex d IIB /Ex d IIC	IP66*	Zone 1 - Zone 21 - Zone 2 - Zone 22
DUST	II2D Ex tb IIIC	IP66	❄️-20°C ÷ ☀️+40°C ❄️-50°C ÷ ☀️+80°C

Materiale : Acciaio zincato
Materiale : acciaio inox AISI 304 (Y)
a richiesta
Guarnizioni : EPDM* (a richiesta per protezione GAS)

Guarnizioni : Silicone
a richiesta

Material : Galvanized steel
Material : Stainless steel inox AISI 304 (Y)
Gaskets : EPDM* (on request for GAS protection)

Gaskets : Silicon
on request



Codice Code (Gk) IIB	Codice Code (NPT) IIB	Codice Code (Gk) IIC	Codice Code (NPT) IIC	Ø	ØA	B IIB	B IIC	ØC	Peso IIB Weight [kg]	Peso IIC Weight [kg]
BMF 1	BMF 1N	BMF 1H	BMF 1NH	½	35	60	65	13.5	0,146	0,234
BMF 2	BMF 2N	BMF 2H	BMF 2NH	¾	42	60	65	19	0,200	0,248
BMF 3	BMF 3N	BMF 3H	BMF 3NH	1	52	76	76	24.5	0,352	0,428
BMF 4	BMF 4N	BMF 4H	BMF 4NH	1¼						
BMF 5	BMF 5N	BMF 5H	BMF 5NH	1½	70	82	82	38.5	0,726	0,875
BMF 6	BMF 6N	BMF 6H	BMF 6NH	2	84	85	85	48	0,994	1,100
BMF 7	BMF 7N	BMF 7H	BMF 7NH	2½						
BMF 8	BMF 8N	BMF 8H	BMF 8NH	3	132	98	98	73	2,300	-
BMF 9	BMF 9N	BMF 9H	BMF 9NH	4	140	110	110	102.5	2,600	-

Codice Code (Gk) IIB	Codice Code (NPT) IIB	Codice Code (Gk) IIC	Codice Code (NPT) IIC	Ø	ØA	B IIB	B IIC	ØC	Peso IIB Weight [kg]	Peso IIC Weight [kg]
BFF 1	BFF 1N	BFF 1H	BFF 1NH	½	35	49	49	13.5	0,126	0,170
BFF 2	BFF 2N	BFF 2H	BFF 2NH	¾	42	49	49	19	0,166	0,300
BFF 3	BFF 3N	BFF 3H	BFF 3NH	1	52	62	62	24.5	0,238	0,368
BFF 4	BFF 4N	BFF 4H	BFF 4NH	1¼						
BFF 5	BFF 5N	BFF 5H	BFF 5NH	1½	70	62	62	38.5	0,620	0,790
BFF 6	BFF 6N	BFF 6H	BFF 6NH	2	84	67	67	48	0,876	0,978
BFF 7	BFF 7N	BFF 7H	BFF 7NH	2½						
BFF 8	BFF 8N	BFF 8H	BFF 8NH	3	132	74	74	73	2,800	-
BFF 9	BFF 9N	BFF 9H	BFF 9NH	4	140	83	83	102.5	-	-

Codice Code (Gk) IIB	Codice Code (NPT) IIB	Codice Code (Gk) IIC	Codice Code (NPT) IIC	Ø	ØA	B IIB	B IIC	ØC	Peso IIB Weight [kg]	Peso IIC Weight [kg]
BMM 1	BMM 1N	BMM 1H	BMM 1NH	½	35	72	84	13.5	0,170	0,234
BMM 2	BMM 2N	BMM 2H	BMM 2NH	¾	42	72	84	19	0,236	0,268
BMM 3	BMM 3N	BMM 3H	BMM 3NH	1	52	121	121	24.5	0,460	0,522
BMM 4	BMM 4N	BMM 4H	BMM 4NH	1¼						
BMM 5	BMM 5N	BMM 5H	BMM 5NH	1½	70	127	127	38.5	0,884	0,912
BMM 6	BMM 6N	BMM 6H	BMM 6NH	2	84	130	130	48	1,150	1,270
BMM 7	BMM 7N	BMM 7H	BMM 7NH	2½						
BMM 8	BMM 8N	BMM 8H	BMM 8NH	3	132	163	163	73	3200	-
BMM 9	BMM 9N	BMM 9H	BMM 9NH	4	140	175	175	102.5	-	-

Filettatura conica : protezione IP 66
 utilizzare sigillante Loctite 577
 Taper thread : protection IP 66
 use compound Loctite 577



A2



GAS	II2G Ex d IIC /Ex e II
DUST	II2D Ex tb IIIC

IP66
IP66

Zone 1 - Zone 21 - Zone 2 - Zone 22
❄️-20°C ÷ ☀️+40°C ❄️-50°C ÷ ☀️+80°C

Materiale tubo : Acciaio inox AISI 304
 Materiale calza: Acciaio inox AISI 304
 Materiale raccordo: Acciaio zincato
 Materiale raccordo: Acciaio inox AISI 304 suffisso Y (FNN ..Y/..) a richiesta
 Material of tube : Stainless steel AISI 304
 Material of braid : Stainless steel AISI 304
 Material end fitting : Galvanized steel
 Material end fitting : Stainless steel AISI 304 suffix Y (FNN .. Y/..) on request

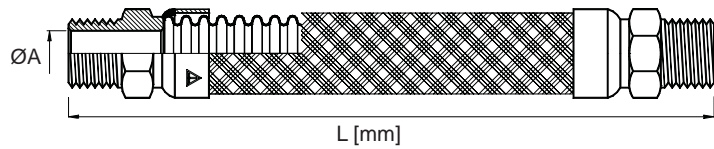

Codice Code (Gk)	Codice Code (NPT)	Ø	ØA
FNN 1/..	FNN 1N/..	½	14
FNN 2/..	FNN 2N/..	¾	19
FNN 3/..	FNN 3N/..	1	25
FNN 4/..	FNN 4N/..	1¼	
FNN 5/..	FNN 5N/..	1½	38
FNN 6/..	FNN 6N/..	2	48
FNN 7/..	FNN 7N/..	2½	65
FNN 8/..	FNN 8N/..	3	70
FNN 9/..	FNN 9N/..	4	192

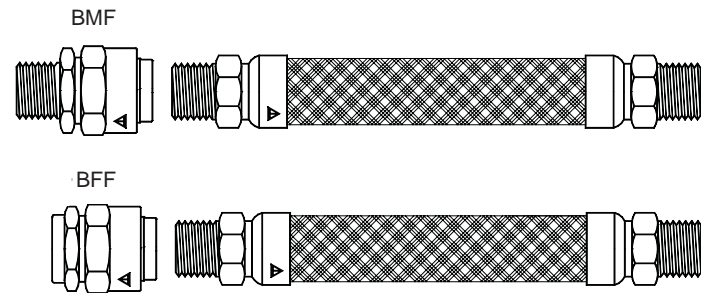

Codice Code (Gk)	L	Peso Weight [kg]
FNN 1/30	300±6	
FNN 1/42	425±6	
FNN 1/50	500±10	
FNN 1/60	600±10	
FNN 1/70	700±10	
FNN 1/80	800±10	
FNN 1/90	900±15	
FNN 1/100	1000±15	

Codice Code (Gk)	L	Peso Weight [kg]
FNN 2/30	300±6	
FNN 2/42	425±6	
FNN 2/50	500±10	
FNN 2/60	600±10	
FNN 2/70	700±10	
FNN 2/80	800±10	
FNN 2/90	900±15	
FNN 2/100	1000±15	

Codice Code (Gk)	L	Peso Weight [kg]
FNN 3/30	300±6	
FNN 3/40	425±6	
FNN 3/50	500±10	
FNN 3/60	600±10	
FNN 3/70	700±10	
FNN 3/80	800±10	
FNN 3/90	900±15	
FNN 3/100	1000±15	

Codice Code (Gk)	L	Peso Weight [kg]
FNN 5/40	400±10	
FNN 5/45	450±10	
FNN 5/50	500±10	
FNN 5/60	600±10	
FNN 5/70	700±10	
FNN 5/80	800±10	
FNN 5/90	900±15	
FNN 5/100	1000±15	

Codice Code (Gk)	L	Peso Weight [kg]
FNN 6/40	400±10	
FNN 6/45	450±10	
FNN 6/50	500±10	
FNN 6/60	600±10	
FNN 6/70	700±10	
FNN 6/80	800±10	
FNN 6/90	900±15	
FNN 6/100	1000±15	

Codice Code (Gk)	L	Peso Weight [kg]
-	-	-
-	-	-
FNN 7/50	500±10	
FNN 7/60	600±10	
FNN 6/70	700±10	
FNN 7/80	800±10	
FNN 7/90	900±15	
FNN 7/100	1000±15	

Codice Code (Gk)	L	Peso Weight [kg]
-	-	-
-	-	-
FNN 8/50	500±10	
FNN 8/60	600±10	
FNN 8/70	700±10	
FNN 8/80	800±10	
FNN 8/90	900±15	
FNN 8/100	1000±15	

Codice Code (Gk)	L	Peso Weight [kg]
-	-	-
-	-	-
-	-	-
-	-	-
FNN 9/70	700±10	
FNN 9/80	800±10	
FNN 9/90	900±15	
FNN 9/100	1000±15	

Altre lunghezze a richiesta max. 5000 mm
 Other lenght upon request max. 5000 mm

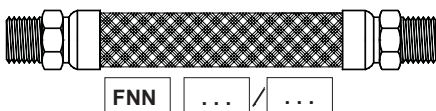

Filettatura conica : protezione IP 66
 utilizzare sigillante Loctite 577
 Taper thread : protection IP 66
 use compound Loctite 577



GAS II2G Ex d IIB

Zone 1 - Zone 2

❄️-20°C ÷ ☀️+40°C

Materiale : Lega leggera
Viti : Acciaio zincato
Viti a richiesta : Acciaio inox

Material : Light alloy
Screws : Galvanized steel
Screws on request : Stainless steel



Codice Code (Gk)	Codice Code (NPT)	Ø	A	C	E	H	R	Peso Weight [kg]
LBH 1	LBH 1N	½	70	132	95	165	21	0,434
LBH 2	LBH 2N	¾	70	132	95	165	21	0,404
LBH 3	LBH 3N	1	70	132	112	168	30	0,455
LBH 4	LBH 4N	1¼	100	175	155	230	50	1,277
LBH 5	LBH 5N	1½	110	220	132	265	70	1,142
LBH 6	LBH 6N	2	110	220	132	265	70	1,024
LBH 7	LBH 7N	2½	136	267	250	363	96	3,569
LBH 8	LBH 8N	3	136	267	250	363	96	3,171
LBH 9	LBH 9N	4	181	605	305	720	125	10,850

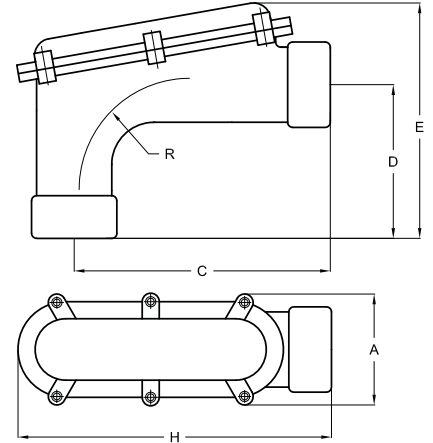

GAS II2G Ex d IIC /Ex e II

IP66

Zone 1 - Zone 21 - Zone 2 - Zone 22

DUST II2D Ex tD A21

IP66

❄️-20°C ÷ ☀️+40°C

❄️-50°C ÷ ☀️+80°C

Materiale : Lega leggera

Material : Light alloy

Codice Code (Gk)	Codice Code (NPT)	Ø	A	H	R	Peso Weight [kg]
ELF 1L	ELF 1LN	½	41	55	20	0,055
ELF 2L	ELF 2LN	¾	50	66	30	0,100
ELF 3L	ELF 3LN	1	66	88	35	0,200
ELF 4L	ELF 4LN	1¼	81	111	50	0,395
ELF 5L	ELF 5LN	1½	81	111	50	0,370
ELF 6L	ELF 6LN	2	94	131	60	0,625
ELF 7L	ELF 7LN	2½	110	155	65	0,880
ELF 8L	ELF 8LN	3	154	205	85	1,480
ELF 9L	ELF 9LN	4	163	220	100	2,345

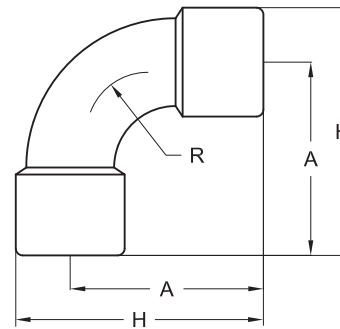

Filettatura conica : protezione IP 66
utilizzare sigillante Loctite 577
Taper thread : protection IP 66
use compound Loctite 577



GAS	II2G Ex d IIC /Ex e II
DUST	II2D Ex tD A21

IP66
IP66

Zone 1 - Zone 21 - Zone 2 - Zone 22
❄️-20°C ÷ ☀️+40°C ❄️-50°C ÷ ☀️+80°C

Materiale : Acciaio zincato
 Materiale : Acciaio inox AISI 304 (Y)
 a richiesta Acciaio inox AISI 316 (YS)
 Material : Galvanized steel
 Material : Stainless steel inox AISI 304 (Y)
 on request Stainless steel inox AISI 316 (YS)

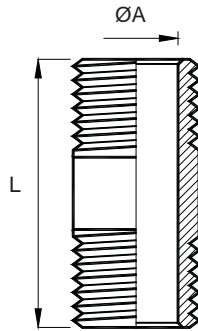

Codice Code (Gk)	Codice Code (NPT)	Ø	ØA	L
NP 1	NP 1N	½	14	70
NP 2	NP 2N	¾	19	70
NP 3	NP 3N	1	25	60
NP 4	NP 4N	1¼	31	55
NP 5	NP 5N	1½	38	55
NP 6	NP 6N	2	48	55
NP 7	NP 7N	2½	65	68
NP 8	NP 8N	3	70	68
NP 9	NP 9N	4	192	68

Filettatura conica : protezione IP 66
 utilizzare sigillante Loctite 577
 Taper thread : protection IP 66
 use compound Loctite 577





GAS	II2G Ex d IIC /Ex e II
DUST	II2D Ex tD A21

IP66
IP66

Zone 1 - Zone 21 - Zone 2 - Zone 22
❄️-20°C ÷ ☀️+40°C ❄️-50°C ÷ ☀️+80°C

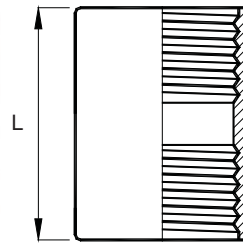
Materiale : Acciaio zincato
 Materiale : Acciaio inox AISI 304 (Y)
 a richiesta Acciaio inox AISI 316 (YS)
 Material : Galvanized steel
 Material : Stainless steel inox AISI 304 (Y)
 on request Stainless steel inox AISI 316 (YS)



Codice Code (Gk)	Codice Code (NPT)	Ø	L
EMU 1	EMU 1N	½	39
EMU 2	EMU 2N	¾	51
EMU 3	EMU 3N	1	51
EMU 4	EMU 4N	1¼	51
EMU 5	EMU 5N	1½	51
EMU 6	EMU 6N	2	65
EMU 7	EMU 7N	2½	65
EMU 8	EMU 8N	3	65
EMU 9	EMU 9N	4	65

Filettatura conica : protezione IP 66
 utilizzare sigillante Loctite 577
 Taper thread : protection IP 66
 use compound Loctite 577





GAS	II2G Ex d IIC /Ex e II
DUST	II2D Ex tb IIIC

IP66
IP66

Zone 1 - Zone 21 - Zone 2 - Zone 22
❄️-20°C ÷ ☀️+40°C ❄️-50°C ÷ ☀️+80°C

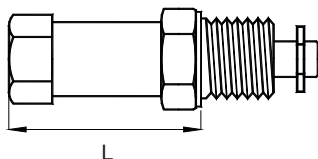
Materiale : Acciaio inox AISI 304 (Y)
 a richiesta Acciaio inox AISI 316 (YS)
 Guarnizione : EPDM (a richiesta Silicone)
 Material : Stainless steel inox AISI 304 (Y)
 on request Stainless steel inox AISI 316 (YS)
 Gasket : EPDM (on request Silicon)



Codice Code	Ø	L
V 28	¼	31
V16	M16x1.5	31

Filettatura conica : protezione IP 66
 utilizzare sigillante Loctite 577
 Taper thread : protection IP 66
 use compound Loctite 577





GAS	II2G Ex d IIB /Ex d IIC	IP66	Zone 1 - Zone 21 - Zone 2 - Zone 22
DUST	II2D Ex tD A21	IP66	❄️-20°C ÷ ☀️+40°C ❄️-40°C ÷ ☀️+80°C

Materiale :	Scatola Lega leggera, Tappo di acciaio zincato
Material :	Light alloy box Galvanized steel plug

Codice Code (Gk)	Codice Code (NPT)	Ø	A	B	MCK [gr]	Peso Weight [kg]
EYS 1	EYS 1N	½	80	47	25	0,118
EYS 2	EYS 2N	¾	90	56	50	0,180
EYS 3	EYS 3N	1	108	69	80	0,294

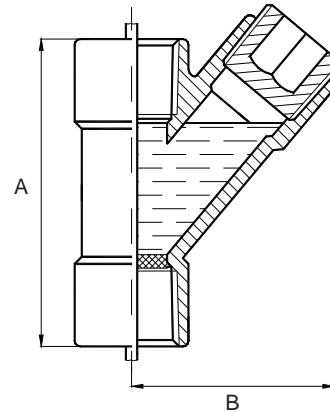

Codice Code (Gk)	Codice Code (NPT)	Ø	A	B	MCK [gr]	Peso Weight [kg]
EZS 1	EZS 1N	½	112	67	110	0,322
EZS 2	EZS 2N	¾	112	69	125	0,344
EZS 3	EZS 3N	1	118	75	180	0,342
EZS 4	EZS 4N	1¼				
EZS 5	EZS 5N	1½	118	83	300	0,424
EZS 6	EZS 6N	2	127	85	450	0,516
EZS 7	EZS 7N	2½				
EZS 8	EZS 8N	3	174	98	1100	1,276
EZS 9	EZS 9N	4	270	126	2800	2,500

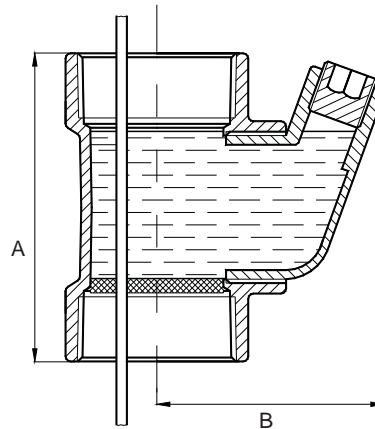

Codice Code	Peso netto resina + catalizzatore Net weight resin + hardner [gr]	Peso Weight [kg]
MCK 125	125	0,200
MCK 250	250	0,300
MCK 1000	1000	1,050

❄️-40°C ÷ ☀️+80°C

Caratteristiche miscela Compound features	
Rapporto di miscelazione in peso Mixing ratio	100 resina / 20 catalizzatore 100 resin / 20 hardner
Peso netto resina + catalizzatore Net weight resin + hardner	125-250-1000 [gr]
Temperatura consigliata di miscelazione Suggested mixing temperature	+10°C ±20°C
Potlife Gel time	15 min 35 ± 10 min
Indurimento completo Complete curing	36 h
Scadenza prodotto Process until	vedere data sulla confezione see date on the label





GAS

II2G Ex d IIC /Ex e II

IP66

Zone 1 - Zone 21 - Zone 2 - Zone 22

DUST

II2D Ex tD A21

IP66

❄️ -20°C ÷ ☀️ +40°C

❄️ -40°C ÷ ☀️ +80°C

Materiale : Acciaio zincato
 Materiale : Acciaio inox AISI 304 (Y)
 a richiesta Acciaio inox AISI 316 (YS)
 Lunghezza : 1 metro (altre lunghezze a richiesta)
 conduttori
 Material : Galvanized steel
 Material : Stainless steel inox AISI 304 (Y)
 on request Stainless steel inox AISI 316 (YS)
 Lenght : 1 meter (other lenght on request)
 conductors

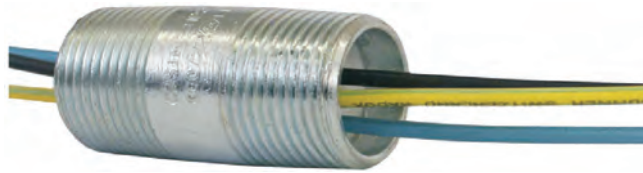

**Caratteristiche elettriche
Electrical features**

Sezione [mm ²] Cross section	Tensione nominale Rated voltage [V]	Corrente nominale per conduttore Rated current for each conductor @Tamb 40°C [A]	Corrente nominale per conduttore Rated current for each conductor @Tamb 55°C [A]	Corrente nominale per conduttore Rated current for each conductor @Tamb 80°C [A]
0,50	450/750	7,5	7	6
0,75	600/1000	10	9	7,5
1	600/1000	12	11	9,5
1,5	600/1000	15	13	11,5
2,5	600/1000	20	18,5	16
4	600/1000	26	23,5	20
6	600/1000	35	31	27
10	600/1000	50	46	40
16	600/1000	70	63	55
25	600/1000	90	80	70
35	600/1000	115	105	90
50	600/1000	140	130	110
70	600/1000	170	155	136

**Numero di conduttori per sezione del conduttore
Number of conductor for conductor section**

Codice Code (Gk)	Ø	0.5 ÷ 1.5 [mm ²]	2.5 [mm ²]	4 [mm ²]	6 [mm ²]	10 [mm ²]	16 [mm ²]	25 [mm ²]	35 [mm ²]	50 [mm ²]	70 [mm ²]
NP 1/RB	½	7	5	4							
NP 2/RB	¾	13	9	7	4	3					
NP 3/RB	1	21	15	11	7	4	3				
NP 4/RB	1¼	36	25	19	11	8	6	4			
NP 5/RB	1½	52	36	28	16	11	8	5	4	3	
NP 6/RB	2	85	59	45	26	18	13	9	7	5	4

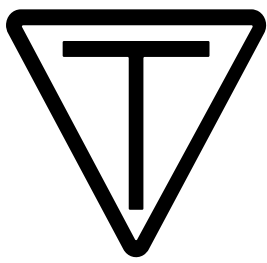

CO.SI.ME.
EQUIPMENT FOR ATEX









GAS	II2G Ex d IIC /Ex e II
DUST	II2D Ex tD A21

IP66
IP66

Zone 1 - Zone 21 - Zone 2 - Zone 22
❄️-20°C ÷ ☀️+40°C ❄️-50°C ÷ ☀️+80°C

Materiale :	Acciaio zincato
Materiale : a richiesta	Lega leggera (L), ottone (D), acciaio inox AISI 304 (Y), AISI 316 (YS)
Guarnizioni :	Sigillante Loctite 577
Material :	Galvanized steel
Materiale : on request	light alloy (L), brass (D), stainless steel inox AISI 304 (Y), AISI 316 (YS)
	Compound Loctite 577

RE	REB	REM
		
Riduzione ad anello maschio-femmina <i>Ring reducer male-female</i>	Riduzione a bicchiere femmina-maschio <i>Glass reducer female-male</i>	Riduzione ad bicchiere femmina-femmina <i>Glass reducer female-female</i>

Codice Code (Gk)	Codice Code (NPT)		Peso Weight [kg]
RE 21	RE 21N	¾ ½	
RE 31	RE 31N	¾ 1	
RE 32	RE 32N	1 ¾	
RE 41	RE 41N	1¼ ½	
RE 42	RE 42N	1¼ ¾	
RE 43	RE 43N	1¼ 1	
RE 51	RE 51N	1½ ½	
RE 52	RE 52N	1½ ¾	
RE 53	RE 53N	1½ 1	
RE 54	RE 54N	1½ 1¼	
RE 61	RE 61N	2 ½	
RE 62	RE 62N	2 ¾	
RE 63	RE 63N	2 1	
RE 64	RE 64N	2 1¼	
RE 65	RE 65N	2 1½	
RE 71	RE 71N	2½ ½	
RE 72	RE 72N	2½ ¾	
RE 73	RE 73N	2½ 1	
RE 74	RE 74N	2½ 1¼	
RE 75	RE 75N	2½ 1½	
RE 76	RE 76N	2½ 2	
RE 81	RE 81N	3 ½	
RE 82	RE 82N	3 ¾	
RE 83	RE 83N	3 1	
RE 84	RE 84N	3 1¼	
RE 85	RE 85N	3 1½	
RE 86	RE 86N	3 2	
RE 87	RE 87N	3 2½	
RE 98	RE 98N	4 3	

Codice Code (Gk)	Codice Code (NPT)		Peso Weight [kg]
REB 21	REB 21N	¾ ½	
REB 31	REB 31N	¾ 1	
REB 32	REB 32N	1 ¾	
REB 41	REB 41N	1¼ ½	
REB 42	REB 42N	1¼ ¾	
REB 43	REB 43N	1¼ 1	
REB 51	REB 51N	1½ ½	
REB 52	REB 52N	1½ ¾	
REB 53	REB 53N	1½ 1	
REB 54	REB 54N	1½ 1¼	
REB 61	REB 61N	2 ½	
REB 62	REB 62N	2 ¾	
REB 63	REB 63N	2 1	
REB 64	REB 64N	2 1¼	
REB 65	REB 65N	2 1½	
REB 71	REB 71N	2½ ½	
REB 72	REB 72N	2½ ¾	
REB 73	REB 73N	2½ 1	
REB 74	REB 74N	2½ 1¼	
REB 75	REB 75N	2½ 1½	
REB 76	REB 76N	2½ 2	
REB 81	REB 81N	3 ½	
REB 82	REB 82N	3 ¾	
REB 83	REB 83N	3 1	
REB 84	REB 84N	3 1¼	
REB 85	REB 85N	3 1½	
REB 86	REB 86N	3 2	
REB 87	REB 87N	3 2½	
REB 98	REB 98N	4 3	

Codice Code (Gk)	Codice Code (NPT)		Peso Weight [kg]
REM 21	REM 21N	½ ½	
REM 31	REM 31N	¾ 1	
REM 32	REM 32N	1 ¾	
REM 41	REM 41N	1¼ ½	
REM 42	REM 42N	1¼ ¾	
REM 43	REM 43N	1¼ 1	
REM 51	REM 51N	1½ ½	
REM 52	REM 52N	1½ ¾	
REM 53	REM 53N	1½ 1	
REM 54	REM 54N	1½ 1¼	
REM 61	REM 61N	2 ½	
REM 62	REM 62N	2 ¾	
REM 63	REM 63N	2 1	
REM 64	REM 64N	2 1¼	
REM 65	REM 65N	2 1½	
REM 71	REM 71N	2½ ½	
REM 72	REM 72N	2½ ¾	
REM 73	REM 73N	2½ 1	
REM 74	REM 74N	2½ 1¼	
REM 75	REM 75N	2½ 1½	
REM 76	REM 76N	2½ 2	
REM 81	REM 81N	3 ½	
REM 82	REM 82N	3 ¾	
REM 83	REM 83N	3 1	
REM 84	REM 84N	3 1¼	
REM 85	REM 85N	3 1½	
REM 86	REM 86N	3 2	
REM 87	REM 87N	3 2½	
REM 98	REM 98N	4 3	





GAS	II2G Ex d IIC /Ex e II	IP66	Zone 1 - Zone 21 - Zone 2 - Zone 22
DUST	II2D Ex tD A21	IP66	❄️-20°C ÷ ☀️+40°C ❄️-50°C ÷ ☀️+80°C

Materiale : Acciaio zincato
 Materiale : Lega leggera (L), ottone (D), acciaio inox
 a richiesta AISI 304 (Y), AISI 316 (YS)
 Guarnizioni : EPDM (filettatura cilindrica)
 Sigillante Loctite 577 (filettatura conica)
 Silicone (*cylindrical thread*)

Guarnizioni :
 a richiesta
Material : Light alloy body
 Materiale : *light alloy (L), brass (D), stainless steel*
 on request *inox AISI 304 (Y), AISI 316 (YS)*

Gaskets : EPDM (*cylindrical thread*)
 Compound Loctite 577 (*taper thread*)
 Silicon (*cylindrical thread*)

Gaskets :
 on request

RE	REB
Adattatore ad anello maschio-femmina <i>Ring adaptor male-female</i>	Adattatore a bicchiere femmina-maschio <i>Glass adaptor female-male</i>

			femmina-female NPT								
			1N	2N	3N	4N	5N	6N	7N	8N	9N
Code	Ø ext.	Gk	18,43	23,76	29,86	38,63	44,72	56,79	67,94	83,82	109,22
maschio-male Gk			½	¾	1	1¼	1½	2	2½	3	4
1	20,96	½									
2	28,44	¾									
3	33,25	1									
4	41,91	1¼									
5	47,80	1½									
6	59,61	2									
7	75,18	2½									
8	87,88	3									
9	113,03	4									

			femmina-female METRICAL PASSO / PITCH 1.5								
			16	20	25	32	40	50	63	75	90
Code	Ø ext.	Gk	14,50	18,50	23,50	30,50	38,50	48,50	61,50	73,50	88,50
maschio-male Gk			M16	M20	M25	M32	M40	M50	M63	M75	M90
1	20,96	½									
2	28,44	¾									
3	33,25	1									
4	41,91	1¼									
5	47,80	1½									
6	59,61	2									
7	75,18	2½									
8	87,88	3									
9	113,03	4									

			femmina - female Gk								
			1	2	3	4	5	6	7	8	9
Code	Ø ext.	Gk	18,63	24,12	30,29	38,95	44,85	56,66	72,23	84,93	110,07
maschio-male NPT			½	¾	1	1¼	1½	2	2½	3	4
1N	21,33	½									
2N	26,67	¾									
3N	33,40	1									
4N	42,17	1¼									
5N	48,26	1½									
6N	60,33	2									
7N	73,02	2½									
8N	88,90	3									
9N	114,30	4									

			femmina-female METRICAL PASSO / PITCH 1.5								
			16	20	25	32	40	50	63	75	90
Code	Ø ext.	Gk	14,50	18,50	23,50	30,50	38,50	48,50	61,50	73,50	88,50
maschio-male NPT			M16	M20	M25	M32	M40	M50	M63	M75	M90
1N	21,33	½									
2N	26,67	¾									
3N	33,40	1									
4N	42,17	1¼									
5N	48,26	1½									
6N	60,33	2									
7N	73,02	2½									
8N	88,90	3									
9N	114,30	4									

			femmina-female NPT								
			1N	2N	3N	4N	5N	6N	7N	8N	9N
Code	Ø ext.		18,43	23,76	29,86	38,63	44,72	56,79	67,94	83,82	109,22
maschio-male M			½	¾	1	1¼	1½	2	2½	3	4
16	21,33	M16									
20	26,67	M20									
25	33,40	M25									
32	42,17	M32									
40	48,26	M40									
50	60,33	M50									
63	73,02	M63									
75	88,90	M75									
90	114,30	M90									

			femmina - female Gk								
			1	2	3	4	5	6	7	8	9
Code	Ø ext.		18,63	24,12	30,29	38,95	44,85	56,66	72,23	84,93	110,07
maschio-male M			½	¾	1	1¼	1½	2	2½	3	4
16	21,33	M16									
20	26,67	M20									
25	33,40	M25									
32	42,17	M32									
40	48,26	M40									
50	60,33	M50									
63	73,02	M63									
75	88,90	M75									
90	114,30	M90									

Filettatura cilindrica
Cylindrical thread

Protezione IP 66 utilizzare guarnizione codice G ..
Protection IP 66 use gasket code G ..

Filettatura conica
Taper thread

Protezione IP 66 utilizzare sigillante Loctite 577
Protection IP 66 use compound Loctite 577

Esempio codice
Sample code

REB

female 2" NPT male M32x1.5

REB 6N.32

B2

GAS
II2G Ex d IIC /Ex e II
DUST
II2D Ex tD A21
IP66
Zone 1 - Zone 21 - Zone 2 - Zone 22
IP66
❄️-20°C ÷ ☀️+40°C
❄️-50°C ÷ ☀️+80°C

Materiale : Acciaio zincato
 Materiale : Lega leggera (L), ottone (D), acciaio inox a richiesta
 AISI 304 (Y), AISI 316 (YS)
 Guarnizioni : EPDM

Guarnizioni : Silicone
 a richiesta

Material : Galvanized steel
 Materiale : light alloy (L), brass (D), stainless steel on request
 inox AISI 304 (Y), AISI 316 (YS)

Gaskets : EPDM

Gaskets : Silicon
 on request



Codice Code)		Peso Weight [kg]
RE 25.20	M25 M20	
RE 32.20	M32 M20	
RE 32.25	M32 M25	
RE 40.20	M40 M20	
RE 40.25	M40 M25	
RE 40.32	M40 M32	
RE 50.20	M50 M20	
RE 50.25	M50 M25	
RE 50.32	M50 M32	
RE 50.40	M50 M40	
RE 63.20	M63 M20	
RE 63.25	M63 M25	
RE 63.32	M63 M32	
RE 63.40	M63 M40	
RE 63.50	M63 M50	
RE 75.20	M75 M20	
RE 75.25	M75 M25	
RE 75.32	M75 M32	
RE 75.40	M75 M40	
RE 75.50	M75 M50	
RE 75.63	M75 M63	
RE 90.20	M90 M20	
RE 90.25	M90 M25	
RE 90.32	M90 M32	
RE 90.40	M90 M40	
RE 90.50	M90 M50	
RE 90.63	M90 M63	
RE 90.75	M90 M75	

Codice Code)		Peso Weight [kg]
REB 25.20	M25 M20	
REB 32.20	M32 M20	
REB 32.25	M32 M25	
REB 40.20	M40 M20	
REB 40.25	M40 M25	
REB 40.32	M40 M32	
REB 50.20	M50 M20	
REB 50.25	M50 M25	
REB 50.32	M50 M32	
REB 50.40	M50 M40	
REB 63.20	M63 M20	
REB 63.25	M63 M25	
REB 63.32	M63 M32	
REB 63.40	M63 M40	
REB 63.50	M63 M50	
REB 75.20	M75 M20	
REB 75.25	M75 M25	
REB 75.32	M75 M32	
REB 75.40	M75 M40	
REB 75.50	M75 M50	
REB 75.63	M75 M63	
REB 90.20	M90 M20	
REB 90.25	M90 M25	
REB 90.32	M90 M32	
REB 90.40	M90 M40	
REB 90.50	M90 M50	
REB 90.63	M90 M63	
REB 90.75	M90 M75	



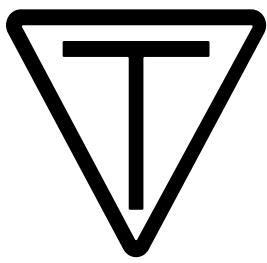

CO.SIME.
EQUIPMENT FOR ATEX





Materiale : Tubo in acciaio zincato, guaina in polivinile
Raccordi di ottone, filettatura ISO 7/1 Rp

Material : Galvanized steel tube, external polivynil
sheat, brass end fittings, ISO 7/1 Rp thread

IP66

Zone Sicura-Safe zone

-40°C ÷ +90°C

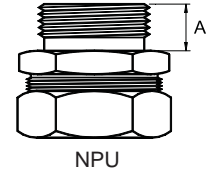
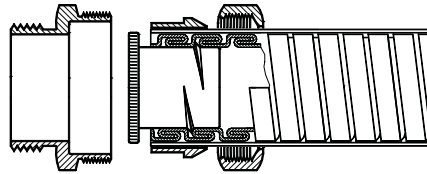
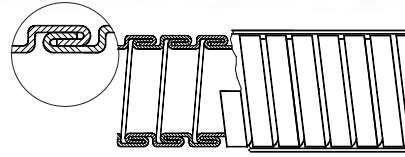

Ø	Codice Code	Diametro interno Internal diameter	Diametro esterno External diameter
½	ADV 12	12	17
¾	ADV 18	18	25
1	ADV 25	25	32
1½	ADV 40	40	48
2	ADV 50	50.5	58.5
3	ADV 75	75	84
4	ADV 100	100	109

Ø	Codice Code	Codice Code	A	D	ØC
½	NPU 1	NPF 1	10	12	10.5
¾	NPU 2	NPF 2	11	18	18.5
1	NPU 3	NPF 3	15	25	23
1½	NPU 5	NPF 5	18	40	37.5
2	NPU 6	NPF 6	18	50.5	48
3	NPU 87	NPF 87	18	75	70
4	NPU 97	NPF 97	18	100	95

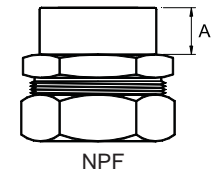
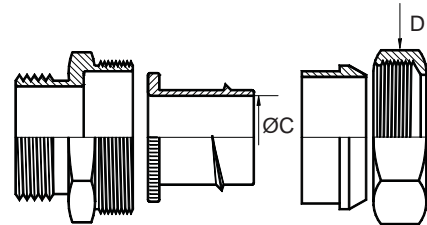

Materiale : Lega leggera
Viti : Acciaio zincato
Viti a richiesta : Acciaio inox
Guarnizione : EPDM

Material : Light alloy
Screws : Galvanized steel
Screws on request : Stainless steel
Gaskets : EPDM

IP65

Zone Sicura-Safe zone

-40°C ÷ +90°C



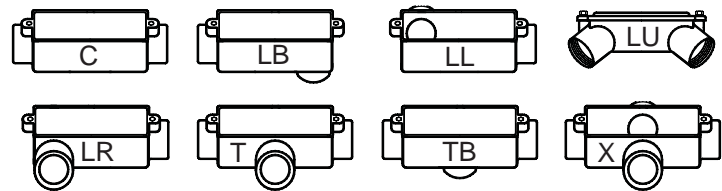

Codice Code (ISO 7/1Rp)	Ø	Peso Weight [kg]
..17	½	
..27	¾	
..37	1	
..47	1¼	
..57	1½	
..67	2	
..77	2½	
..87	3	



Materiale : DB - Lega leggera, DB ..P - poliammide filettatura ISO 7/1Rp
Material : DB - Light alloy, DB ..P - polyamide thread ISO 7/1Rp

Materiale : Acciaio zincato - Norma UNI 7683
Material : Galvanized steel - Standard UNI 7683

Ø	Codice Code		Codice Code	
½	DB 1L		DB 1P	
¾	DB 2L		DB 2P	
1	DB 3L		DB 3P	
1¼	DB 4L		DB 4P	
1½	DB 5L		DB 5P	
2	DB 6L		DB 6P	
2½	DB 7L		DB 7P	
3	DB 8L		DB 8P	
4	DB 9L		DB 9P	

Ø	Codice ISO 7/1Rc Code ISO 7/1Rc	Codice NPT Code NPT
½	TC 1	TC 1N
¾	TC 2	TC 2N
1	TC 3	TC 3N
1¼	TC 4	TC 4N
1½	TC 5	TC 5N
2	TC 6	TC 6N
2½	TC 7	TC 7N
3	TC 8	TC 8N
4	TC 9	TC 9N





CO.SI.ME. ACCESSORI PER IL FISSAGGIO DEL CONDUIT
EQUIPMENT FOR ATEX **ACCESSORIES FOR CONDUIT INSTALLATION**



Materiale : Acciaio zincato
a richiesta : acciaio inox AISI 304
Material : Galvanized steel
on request : Stainless steel AISI 304

Materiale : Acciaio zincato
a richiesta : acciaio inox AISI 304
Material : Galvanized steel
on request : Stainless steel AISI 304

Ø	Codice Code		ØA	Peso Weight [kg]
½	GH 1		5	
¾	GH 2		6	
1	GH 3		6	
1¼	GH 4		6	
1½	GH 5		8	
2	GH 6		8	
2½	GH 7		8	
3	GH 8		8	
4	GH 9		8	

Ø	Codice Code		A	B	C	Peso Weight [kg]
½ ÷ ¾	MP 12		75	29÷35	30	
¾			-	-	-	
1	MP 34		100	42÷50	35	
1¼			-	-	-	
1½ ÷ 2	MP 56		125	58÷68	40	
2			-	-	-	
2½ ÷ 3	MP 78		160	90	50	
3			-	-	-	
4	MP 9		185	100	60	

Ø	Codice Code		ØA	Peso Weight [kg]
½	GF 1		7	
¾	GF 2		7	
1	GF 3		7	
1¼	GF 4		9	
1½	GF 5		9	
2	GF 6		9	
2½	GF 7		9	
3	GF 8		11	
4	GF 9		13	

Ø	Codice Code		A	B	C	Peso Weight [kg]
½ ÷ ¾	MT 12		63	44	57	
¾			-	-	-	
1	MT 3		70	44	57	
1¼			-	-	-	
1½ ÷ 2	MT 45		95	50	99	
2	MT 6		110	50	99	
2½ ÷ 3	MT 8		150	60	135	
3			-	-	-	
4	MT 9		184	60	161	



Materiale : Lega leggera
filettatura ISO 7/1Rp

Material : Light alloy
thread ISO 7/1Rp



Ø	Codice Code	Vite di terra Earth screw
½	DBT 1	M5
¾	DBT 2	M5
1	DBT 3	M5
1¼	DBT 4	M6
1½	DBT 5	M6
2	DBT 6	M6
2½	DBT 7	M6
3	DBT 8	M6
4	DBT 9	M6

BARRA DI TERRA
EARTH BUS BAR

Materiale : Rame nichelato
a richiesta Acciaio inox AISI 304

Material : Nickel plated copper
on request Stainless steel AISI 304

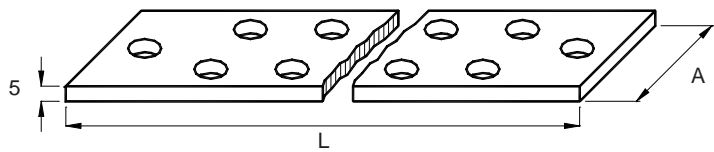

Codice Code	N° fori holes N°	Ø fori holes Ø	A	L	Peso Weight [kg]
BTH 4	8	11	50	255	
BTH 5	10	11	50	300	
BTH 6	12	11	50	345	

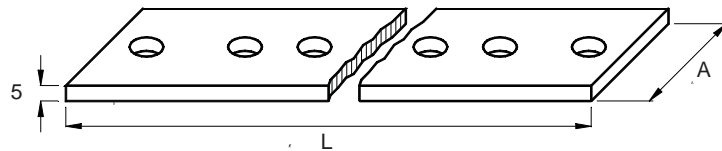

Codice Code	N° fori holes N°	Ø fori holes Ø	A	L	Peso Weight [kg]
BTM 4	4	11	50	255	
BTM 5	5	11	50	300	
BTM 6	6	11	50	345	

COLLARE DI TERRA
EARTH COLLAR



Materiale : Zama zincata

Material : Galvanized aluminium zinc alloy



Ø	Codice Code	Vite di terra Earth screw	Sezione Sezione	Peso Weight [kg]
½	GVC 1	M5	35 mm ²	0,060
¾	GVC 2	M5	35 mm ²	0,070
1	GVC 3	M6	35 mm ²	0,080
1¼	GVC 4	M6	35 mm ²	0,090
1½	GVC 5	M6	35 mm ²	0,100
2	GVC 6	M6	35 mm ²	0,140

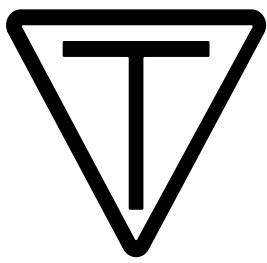

CO.SI.ME.
EQUIPMENT FOR ATEX



	GAS	II2G Ex d IIC /Ex e II	IP66	Zone 1 - Zone 21 - Zone 2 - Zone 22
	DUST	II2D Ex tD A21	IP66	❄️-20°C ÷ ☀️+40°C ❄️-40°C ÷ ☀️+90°C

Materiale : Acciaio zincato
 Materiale : Lega leggera (L), ottone (D), acciaio inox
 a richiesta AISI 304 (Y), AISI 316 (YS)
 Anelli di tenuta : EPDM
 Guarnizioni : EPDM
 Guarnizioni : Silicone
 a richiesta

Material : Galvanized steel
 Material : light alloy (L), brass (D), stainless steel
 on request inox AISI 304 (Y), AISI 316 (YS)
 sealing rings : EPDM
 Gaskets : EPDM
 Gaskets : Silicon
 on request

**PER CAVO NON ARMATO
FOR UNARMoured CABLE**

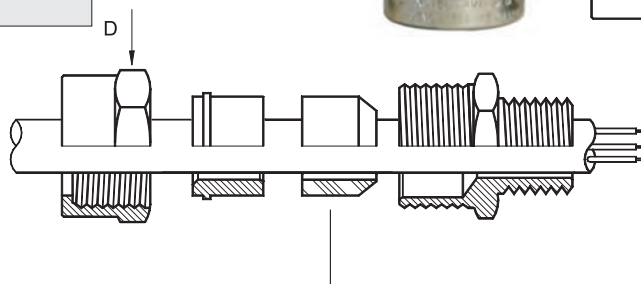
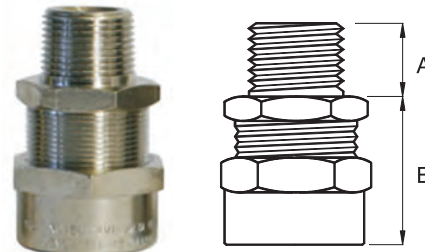

Codice Code (Gk)	Codice Code (NPT)	Ø	D	A	B MAX	TYPE	Ø MIN	Ø MAX	Peso Weight [kg]
PNA 0..	PNA 0N..	½	27	20	46	PX 10	4	10	0,122
PNA 1..	PNA 1N..	½	38	20	45	PX 12	6	12	0,227
PNA 12..	PNA 12N..	¾	38	20	45	PX 12	6	12	0,260
PNA 2..	PNA 2N..	¾	46	20	47	PX 17	9	17	0,314
PNA 3..	PNA 3N..	1	56	26	49	PX 23	14	23	0,452
PNA 4..	PNA 4N..	1¼							
PNA 5A..	PNA 5AN..	1½	67	26	52	PX 29	19	29	0,820
PNA 5B..	PNA 5BN..	1½	72	26	52	PX 36	28	36	0,796
PNA 6..	PNA 6N..	2	83	26	57	PX 45	34	45	1,406
PNA 7..	PNA 7N..	2½							
PNA 8..	PNA 8N..	3	108	31	60	PX 59	47	59	3,000

Codice Code (METRICAL pitch 1.5)	Ø	D	A	B MAX	TYPE	Ø MIN	Ø MAX	Peso Weight [kg]
PNA 0M..	M20	27	15	46	PX 10	4	10	0,111
PNA 1M..	M20	38	15	45	PX 12	6	12	0,216
PNA 2M..	M25	46	15	47	PX 17	9	17	0,296
PNA 3M..	M32	56	15	49	PX 23	14	23	0,408
PNA 5AM..	M40	67	15	52	PX 29	19	29	0,668
PNA 5BM..	M50	72	15	52	PX 36	28	36	0,760
PNA 6M..	M63	83	15	57	PX 45	34	45	1,360
PNA 7M..	M75	108	15	60	PX 59	47	59	
PNA 8M..	M90							



GAS	II2G Ex d IIC /Ex e II	IP66	Zone 1 - Zone 21 - Zone 2 - Zone 22
DUST	II2D Ex tD A21	IP66	❄️-20°C ÷ ☀️+40°C ❄️-40°C ÷ ☀️+90°C

Materiale : Acciaio zincato
Materiale : Lega leggera (L), ottone (D), acciaio inox a richiesta
Anelli di tenuta : EPDM
Guarnizioni : EPDM
Guarnizioni : Silicone a richiesta

Material : Galvanized steel
Material : light alloy (L), brass (D), stainless steel
on request
sealing rings : EPDM
Gaskets : EPDM
Gaskets : Silicon on request

**PER CAVO NON ARMATO
FOR UNARMoured CABLE**

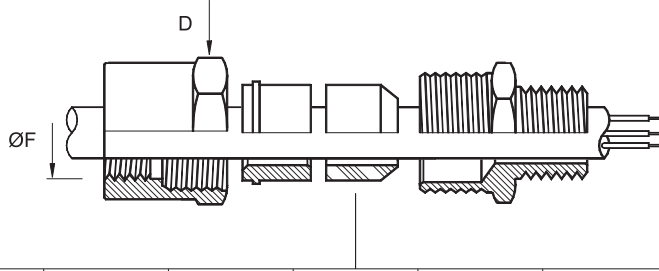

Codice Code (Gk)	Codice Code (NPT)	Ø	D	A	B MAX	TYPE	Ø MIN	Ø MAX	ØF ISO 7/1 Rp	Peso Weight [kg]
PNA 0F..	PNA 0NF..	½								
PNA 1F..	PNA 1FN..	½	38	20	56	PX 12	6	12	½	0,260
PNA 12F..	PNA 12FN..	¾	38	20	56	PX 12	6	12	¾	0,280
PNA 2F..	PNA 2FN..	¾	46	20	58	PX 17	9	17	¾	0,364
PNA 3F..	PNA 3FN..	1	56	26	63	PX 23	14	23	1	0,558
PNA 4F..	PNA 4FN..	1¼								
PNA 5AF..	PNA 5AFN..	1½	67	26	68	PX 29	19	29	1½	0,890
PNA 5BF..	PNA 5BFN..	1½	72	26	68	PX 36	28	36	1½	0,954
PNA 6F..	PNA 6FN..	2	83	26	75	PX 45	34	45	2	1,490
PNA 7F..	PNA 7FN..	2½								
PNA 8F..	PNA 8FN..	3	108	31	80	PX 59	47	59	3	3,000

Codice Code (METRICAL pitch 1.5)	Ø	D	A	B MAX	TYPE	Ø MIN	Ø MAX	ØF ISO 7/1 Rp	Peso Weight [kg]
PNA 0FM..	M20								
PNA 1FM..	M20	38	15	56	PX 12	6	12	½	0,200
PNA 2FM..	M25	46	15	58	PX 17	9	17	¾	0,256
PNA 3FM..	M32	56	15	63	PX 23	14	23	1	0,390
PNA 5AFM..	M40	67	15	68	PX 29	19	29	1½	0,524
PNA 5BFM..	M50	72	15	68	PX 36	28	36	1½	0,810
PNA 6FM..	M63	83	15	75	PX 45	34	45	2	0,994
PNA 7FM..	M75	108	15	60	PX 59	47	59	3	2,900
PNA 8FM..	M90								

D2



GAS	II2G Ex d IIC /Ex e II
DUST	II2D Ex tD A21

IP66
IP66

Zone 1 - Zone 21 - Zone 2 - Zone 22
❄️-20°C ÷ ☀️+40°C ❄️-40°C ÷ ☀️+90°C

Materiale : Acciaio zincato
 Materiale : Lega leggera (L), ottone (D), acciaio inox
 a richiesta AISI 304 (Y), AISI 316 (YS)
 Anelli di tenuta : EPDM
 Guarnizioni : EPDM
 Guarnizioni : Silicone
 a richiesta

Material : Galvanized steel
 Material : light alloy (L), brass (D), stainless steel
 on request inox AISI 304 (Y), AISI 316 (YS)
 sealing rings : EPDM
 Gaskets : EPDM
 Gaskets : Silicon
 on request

**PER CAVO ARMATO
FOR ARMoured CABLE**

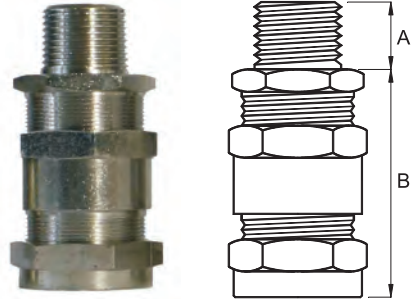
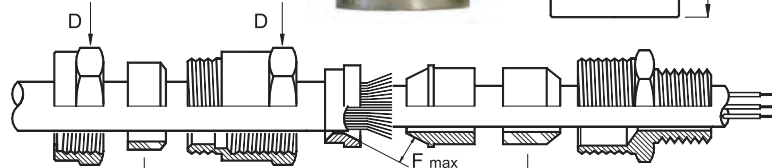
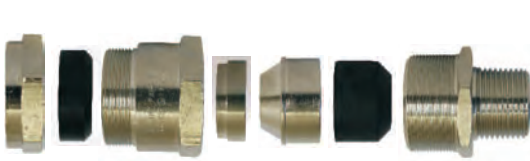

Codice Code (Gk)	Codice Code (NPT)	Ø	D	TYPE	Ø MIN	Ø MAX	A	B MAX	TYPE	Ø MIN	Ø MAX	F MAX	Peso Weight [kg]
PAP 0..	PAP 0N..	½	27	P 15	7	15	20	68	PX 10	4	10	2	0,162
PAP 1..	PAP 1N..	½	38	P 21	10	21	20	75	PX 12	6	12	2	0,328
PAP 2A..	PAP 2AN..	¾	38	P 21	10	21	20	75	PX 12	6	12	2	0,362
PAP 2B..	PAP 2BN..	¾	46	P 27	16	27	20	77	PX 17	9	17	2	0,460
PAP 3..	PNA 3N..	1	56	P 33	19	33	26	81	PX 23	14	23	2.5	0,658
PAP 4..	PNA 4N..	1¼											
PAP 5A..	PNA 5AN..	1½	67	P 43	26	43	26	93	PX 29	19	29	3	1,140
PAP 5B..	PNA 5BN..	1½	72	P 47	32	47	26	93	PX 36	28	36	3	1,114
PAP 6..	PNA 6N..	2	83	P 58	38	58	26	102	PX 45	34	45	3	1,832
PAP 7..	PNA 7N..	2½											
PAP 8..	PNA 8N..	3	108	P 70	48	70	31	115	PX 59	47	59	4	4,100

Codice Code (METRICAL pitch 1.5)	Ø	D	TYPE	Ø MIN	Ø MAX	A	B MAX	TYPE	Ø MIN	Ø MAX	F MAX	Peso Weight [kg]
PAP 0M..	M20	27	P 15	7	15	15	68	PX 10	4	10	2	0,150
PAP 1M..	M20	38	P 21	10	21	15	75	PX 12	6	12	2	0,318
PAP 2BM..	M25	46	P 27	16	27	15	77	PX 17	9	17	2	0,440
PAP 3M..	M32	56	P 33	19	33	15	81	PX 23	14	23	2.5	0,614
PAP 5AM..	M40	67	P 43	26	43	15	93	PX 29	19	29	3	0,994
PAP 5BM..	M50	72	P 47	32	47	15	93	PX 36	28	36	3	1,100
PAP 6M..	M63	83	P 58	38	58	15	102	PX 45	34	45	3	1,650
PAP 7M..	M75	108	P 70	48	70	15	115	PX 59	47	59	4	3,900
PAP 8M..	M90											



GAS	II2G Ex d IIC /Ex e II	IP66	Zone 1 - Zone 21 - Zone 2 - Zone 22
DUST	II2D Ex tD A21	IP66	❄️-20°C ÷ ☀️+40°C ❄️-40°C ÷ ☀️+90°C

Materiale : Acciaio zincato
 Materiale : Lega leggera (L), ottone (D), acciaio inox a richiesta
 Anelli di tenuta : EPDM
 Guarnizioni : EPDM
 Guarnizioni : Silicone a richiesta

Material : Galvanized steel
 Material : light alloy (L), brass (D), stainless steel on request
 sealing rings : EPDM
 Gaskets : EPDM
 Gaskets : Silicon on request

PER CAVO NON ARMATO
FOR UNARMoured CABLE

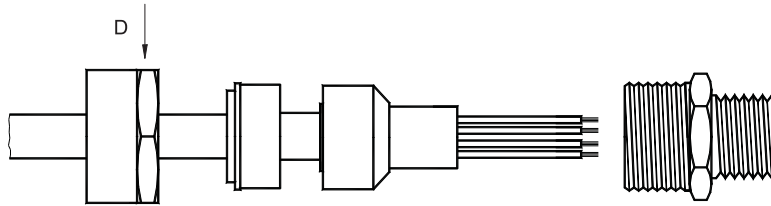
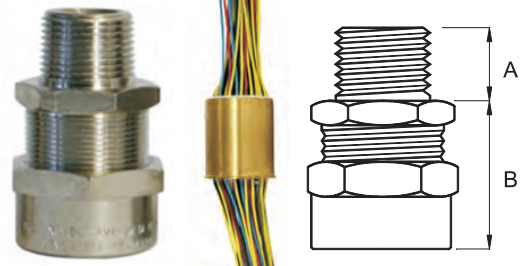

Codice Code (Gk)	Codice Code (NPT)	Ø	D	A	B MAX	Peso Weight [kg]
PNAB 0..	PNAB 0N..	½	27	20	46	
PNAB 1..	PNAB 1N..	½	38	20	56	
PNAB 12..	PNAB 12N..	¾	38	20	56	
PNAB 2..	PNAB 2N..	¾	46	20	58	
PNAB 3F..	PNAB 3N..	1	56	26	63	
PNAB 4F..	PNAB 4N..	1¼				
PNAB 5AF..	PNAB 5AN..	1½	67	26	68	
PNAB 5BF..	PNAB 5BN..	1½	72	26	68	
PNAB 6F..	PNAB 6N..	2	83	26	75	

Codice Code (METRICAL pitch 1.5)	Ø	D	A	B MAX	Peso Weight [kg]
PNAB 0M..	M20	15	20	46	
PNAB 1M..	M20	38	15	56	
PNAB 2M..	M25	46	15	58	
PNAB 3M..	M32	56	15	63	
PNAB 5AM..	M40	67	15	68	
PNAB 5BM..	M50	72	15	68	
PNAB 6M..	M63	83	15	75	

Grandezza / Size	Sezione conduttore / Conductor section [mm²]									
	0.5+1.5	2.5	4	6	10	16	25	35	50	70
0	3 (0,5)	-	-	-	-	-	-	-	-	-
1	3	1	-	-	-	-	-	-	-	-
2	7	5	4	2	1	-	-	-	-	-
3	12	9	7	4	3	2	-	-	-	-
5A	19	13	10	6	4	3	2	-	-	-
5B	32	22	17	10	7	5	3	3	2	-
6	52	36	28	16	11	8	6	4	3	2

D4



GAS	II2G Ex d IIC /Ex e II
DUST	II2D Ex tD A21

IP66
IP66

Zone 1 - Zone 21 - Zone 2 - Zone 22
❄️-20°C ÷ ☀️+40°C ❄️-40°C ÷ ☀️+90°C

Materiale : Acciaio zincato
 Materiale : Lega leggera (L), ottone (D), acciaio inox
 a richiesta AISI 304 (Y), AISI 316 (YS)
 Anelli di tenuta : EPDM
 Guarnizioni : EPDM
 Guarnizioni : Silicone
 a richiesta

Material : Galvanized steel
 Material : light alloy (L), brass (D), stainless steel
 on request inox AISI 304 (Y), AISI 316 (YS)
 sealing rings : EPDM
 Gaskets : EPDM
 Gaskets : Silicon
 on request

PER CAVO ARMATO
FOR ARMoured CABLE

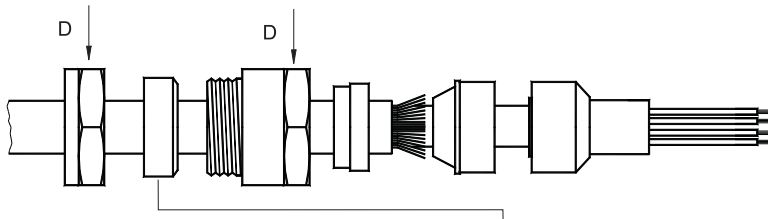
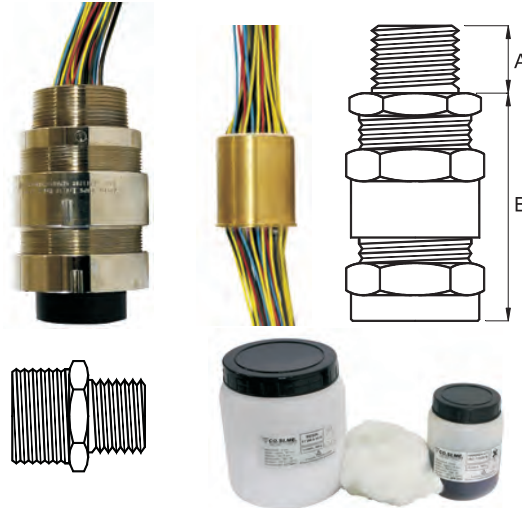

Codice Code (Gk)	Codice Code (NPT)	Ø	D	TYPE	Ø MIN	Ø MAX	A	B MAX	F MAX	Peso Weight [kg]
PAPB 0..	PAPB 0N..	½	27	P 15	7	15	20	68	2	
PAPB 1..	PAPB 1N..	½	38	P 21	10	21	20	75	2	
PAPB 2A..	PAPB 2AN..	¾	38	P 21	10	21	20	75	2	
PAPB 2B..	PAPB 2BN..	¾	46	P 27	16	27	20	77	2	
PAPB 3..	PNAB 3N..	1	56	P 33	19	33	26	81	2.5	
PAPB 4..	PNAB 4N..	1¼								
PAPB 5A..	PNAB 5AN..	1½	67	P 43	26	43	26	93	3	
PAP 5B..	PNA 5BN..	1½	72	P 47	32	47	26	93	3	
PAP 6..	PNA 6N..	2	83	P 58	38	58	26	102	3	

Codice Code (METRICAL pitch 1.5)	Ø	D	TYPE	Ø MIN	Ø MAX	A	B MAX	F MAX	Peso Weight [kg]
PAPB 0M..	M20	27	P 15	7	15	15	68	2	
PAPB 1M..	M20	38	P 21	10	21	15	75	2	
PAPB 2BM..	M25	46	P 27	16	27	15	77	2	
PAPB 3M..	M32	56	P 33	19	33	15	81	2.5	
PAPB 5AM..	M40	67	P 43	26	43	15	93	3	
PAPB 5BM..	M50	72	P 47	32	47	15	93	3	
PAPB 6M..	M63	83	P 58	38	58	15	102	3	

Grandezza / Size	Sezione conduttore / Conductor section [mm²]									
	0.5+1.5	2.5	4	6	10	16	25	35	50	70
0	3 (0,5)	-	-	-	-	-	-	-	-	-
1	3	1	-	-	-	-	-	-	-	-
2	7	5	4	2	1	-	-	-	-	-
3	12	9	7	4	3	2	-	-	-	-
5A	19	13	10	6	4	3	2	-	-	-
5B	32	22	17	10	7	5	3	3	2	-
6	52	36	28	16	11	8	6	4	3	2

D5



GAS	II2G Ex e II	IP66	Zone 1 - Zone 21 - Zone 2 - Zone 22
DUST	II2D Ex tD A21	IP66	❄️-20°C ÷ ☀️+40°C ❄️-40°C ÷ ☀️+90°C

Materiale : Poliammide nero
Anelli di tenuta : EPDM

Material : Black polyamide
Sealing rings : EPDM



Codice Code	Ø	Ø MIN	Ø MAX	Peso Weight [kg]
PE M12P	M12	4	6,5	
PE M16P	M16	6	10	
PE M20P	M20	8	14	
PE M25P	M25	13	18	
PE M32P	M32	18	25	
PE M40P	M40	22	32	
PE M50P	M50	30	38	
PE M63P.	M63	34	44	

**CONTRODADO
LOCKNUT**

DL

**ACCESSORI
ACCESSORIES**

Ø	Poliammide Polyamide			Ottone Brass			Acciaio inox Stainless steel			Guarnizione EPDM EPDM gasket		Protettore in gomma Rubber shroud	
	Codice Code		Codice Code		Codice Code		Ø	Codice Code		Grandezza Size	Codice Code		
M12	DL M12P		DL 12MD		DL 12MY		M12	G 12		0	PGA 0		
M16	DL M16P		DL 16MD		DL 16MY		M16	G 16		1-2A-12	PGA 2		
M20	DL M20P		DL 1MD		DL 1MY		M20	G 1		2-2B	PGA 3		
M25	DL M25P		DL 2MD		DL 2MY		M25	G 2		3	PGA 4		
M32	DL M32P		DL 3MD		DL 3MY		M32	G 3		5A	PGA 5		
M40	DL M40P		DL 4MD		DL 4MY		M40	G 4		5B	PGA 6		
M50	DL M50P		DL 5MD		DL 5MY		M50	G 5		6	PGA 6		
M63	DL M63P.		DL 6MD		DL 6MY		M63	G 6		8	PGA 8		

Ø Gk NPT	Acciaio Zincato Galvanized steel			Ottone Brass			Acciaio inox Stainless steel			Ottone Brass		Acciaio inox Stainless steel	
	Codice Code		Codice Code		Codice Code		Ø	x1.5	Codice Code		Codice Code		
¼	DL 28		DL 28D		-		¼	-	-	-	-	-	
	DL 38		DL 38D		-			-	-	-	-	-	
½	DL 1 - DL 1N(NPT)		DL 1D - DL 1ND(NPT)		DL 1Y - DL 1NY(NPT)		½	M20	PT 1		PT 1Y		
¾	DL 2 - DL 2N(NPT)		DL 2D - DL 2ND(NPT)		DL 2Y - DL 2NY(NPT)		¾	M25	PT 2		PT 2Y		
1	DL 3 - DL 3N(NPT)		DL 3D - DL 3ND(NPT)		DL 3Y - DL 3NY(NPT)		1	M32	PT 3		PT 3Y		
1¼	DL 4 - DL 4N(NPT)		DL 4D - DL 4ND(NPT)		-		1¼	M40	PT 4		PT 4Y		
1½	DL 5 - DL 5N(NPT)		DL 5D - DL 5ND(NPT)		DL 5Y - DL 5NY(NPT)		1½	M50	PT 5		PT 5Y		
2	DL 6 - DL 6N(NPT)		DL 6D - DL 6ND(NPT)		DL 6Y - DL 6NY(NPT)		2	M63	PT 6		PT 6Y		
2½	DL 7 - DL 7N(NPT)		DL 7D - DL 7ND(NPT)		-		2½	M75	PT 7		PT 7Y		
3	DL 8 - DL 8N(NPT)		DL 8D - DL 8ND(NPT)		-		3	M90	PT 8		PT 8Y		

D6



CO.SI.ME.

EQUIPMENT FOR ATEX





GAS	II2G Ex d IIB+H₂ T6 ÷ T4
DUST	II2D Ex tD A21 T80°C ÷ T130°C

* IP65/IP66
* IP65/IP66

Zone 1 - Zone 21 - Zone 2 - Zone 22
❄️ -20°C ÷ ☀️ +40°C ❄️ -20°C + ☀️ +60°C

Materiale : Corpo e coperchio di lega leggera
 Installazione : con staffe in acciaio zincato a richiesta
 Viteria : Acciaio zincato a richiesta inox
 Guarnizioni : a richiesta al silicone per IP 66
 Suffisso A : Per montaggio elementi a coperchio

Material : Light alloy cover and body
 Installation : Galvanized steel lugs on demand
 Hardware : galvanized steel or stainless steel
 Gaskets : on demand silicon for IP 66
 A suffix : for installation of components on cover

* IP65 con grasso al silicone - IP66 con guarnizione
 IP65 with silicon grease - IP66 with silicon gasket

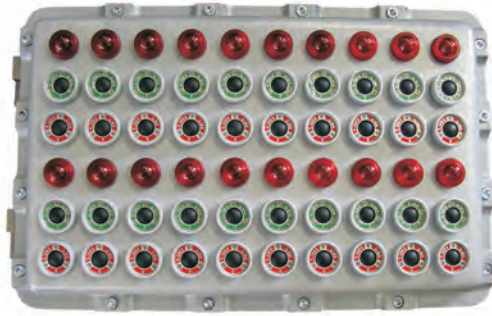

Code Code	A	B	C	a	b	c	c1	A1	B1	H1	H2	x	y	ØF	Peso Weight [kg]
EJB 544A	175	150	120	103	104	91	-	120	90	21	91	94	120	M5	2,400
EJB 544TA	175	150	120	103	104	91	50	120	90	21	91	94	120	M5	2,770
EJB 755A	212	175	140	164	125	116	-	155	115	46	78	100	140	M6	4,200
EJB 755TA	212	175	140	164	125	116	70	155	115	46	78	100	140	M6	4,700
EJB 1076A	305	206	157	252	154	127	86	215	125	57	89	132	224	M6	8,500
EJB 1286A	370	265	200	306	203	158	92	280	180	88	120	163	280	M8	14,500
EJB 14107A	450	307	206	375	232	169	110	345	210	99	131	198	339	M8	19,500
EJB 17129BA	545	373	206	456	288	156	180	450	285	86	118	285	450	M10	37,000
EJB 17129A	545	373	295	456	288	245	88	450	285	175	207	282	450	M10	30,500
EJB 221410A	665	425	305	583	344	250	180	570	340	180	212	315	550	M10	48,000

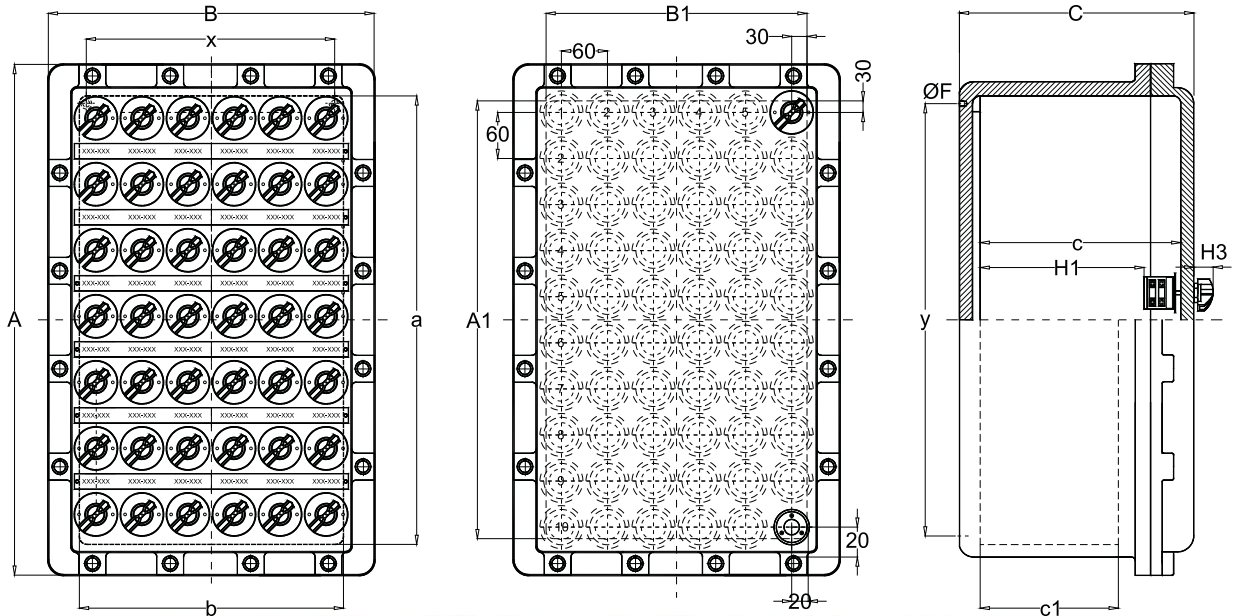

Codice Code	senza targhe without labels	
	Nx	Ny
EJB 544..A	2	1
EJB 755..A	2	2
EJB 1076A	4	2
EJB 1286A	5	3
EJB 14107A	6	4
EJB 17129..A	8	5
EJB 221410A	10	6

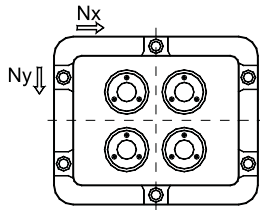

Codice Code	con targhe with labels	
	Nx	Ny
EJB 544..A	2	1
EJB 755..A	2	2
EJB 1076A	4	2
EJB 1286A	4	3
EJB 14107A	6	4
EJB 17129..A	7	5
EJB 221410A	9	6

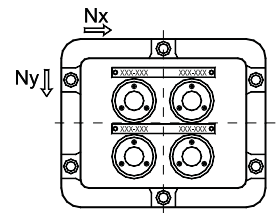

Descrizione/Description	Codice/ Code
Targa Label 	TGY Inox/S.S. TGF Traffolite
Selettore Selector switch 	EFD ..I/C
H3 = 25	
Selettore con guardia Selector switch with guard 	EFD ..I/CL
H3 = 25	
Selettore a chiave Selector key 	EFD ..I/CY
H3 = 25	
Pulsante Push button 	EFD 0 (1NO) EFD 1 (1NC)
H3 = 15	
Pulsante con doppio contatto Push button with double contact 	EFD 0S (1NC+1NO) EFD 1S (1NC+1NO)
Pulsante di test e reset Test and reset push button 	R 28
H3 = 35	
Pulsante emergenza sbocco a rotazione Emergency push button rotate to unlock 	EFD 0FB/C (1NC)
H3 = 55	
Pulsante emergenza a chiave Emergency push button with key 	EFD 0F/BYC (1NC)
H3 = 25	
Segnalatore incandescenza Incandescent signal lamp 	EFD A3L/C blu/blue EFD B3L/C bianco/white EFD G3L/C giallo/yellow EFD R3L/C rosso/red EFD V3L/C verde/green
H3 = 23	
Segnalatore luminoso a led Led Signal 	EFD ..L/C
H3 = 23	

EFD 5		11-12	1	2				
EFD 52		11-12	1	2				
EFD 53		11-12	1	2				
EFD 50		11-12	1	0	2			
EFD 50+		11-12	1	0	2			
EFD 502		11-12	1	0	2			
EFD 502+		11-12	1	0	2			
EFD 503		11-12	1	0	2			
EFD 6		13-14	0	I				
EFD 63		13-14	0	I				
EFD 64		13-14	0	I				
EFD 7		13-14	0	I				
EFD 8		13-14	0	I				
EFD Y		13-14	1	0	0	0	2	



GAS	II2G Ex d IIB+H2 T6 ÷ T4	*IP65/IP66	Zone 1 - Zone 21 - Zone 2 - Zone 22
DUST	II2D Ex tD A21 T80°C ÷ T130°C	*IP65/IP66	❄️-20°C ÷ ☀️+40°C ❄️-20°C ÷ ☀️+60°C

Materiale : Corpo e coperchio di lega leggera
Parte trasparente : Vetro temperato
Installazione : con staffe in acciaio zincato a richiesta
Viteria : Acciaio zincato a richiesta inox
Guarnizioni : a richiesta al silicone per IP 66
Ingresso : vedi tabella

Material : Light alloy cover and body
Transparent part : Tempered glass
Installation : Galvanized steel lugs on demand
Hardware : galvanized steel or stainless steel on demand
Gaskets : on demand silicon for IP 66
Cable entry : see table
 * IP65 con grasso al silicone - IP66 con guarnizione
 IP65 with silicon grease - IP66 with silicon gasket



Codice/Code	A	B	C	a	b	c	A1	B1	H1	H2	x	y	ØF
EJB 544A	175	150	120	103	104	91	120	90	21	91	94	120	M5
EJB 755A	212	175	140	164	125	116	155	115	46	78	100	140	M6
EJB 1076A	305	206	157	252	154	127	215	125	57	89	132	224	M6
EJB 1286A	370	265	200	306	203	158	280	180	88	120	163	280	M8
EJB 14107A	450	307	206	375	232	169	345	210	99	131	198	339	M8
EJB 17129BA	545	373	206	456	288	156	450	285	86	118	285	450	M10
EJB 17129A	545	373	295	456	288	245	450	285	175	207	282	450	M10
EJB 221410A	665	425	305	583	344	250	570	340	180	212	315	550	M10

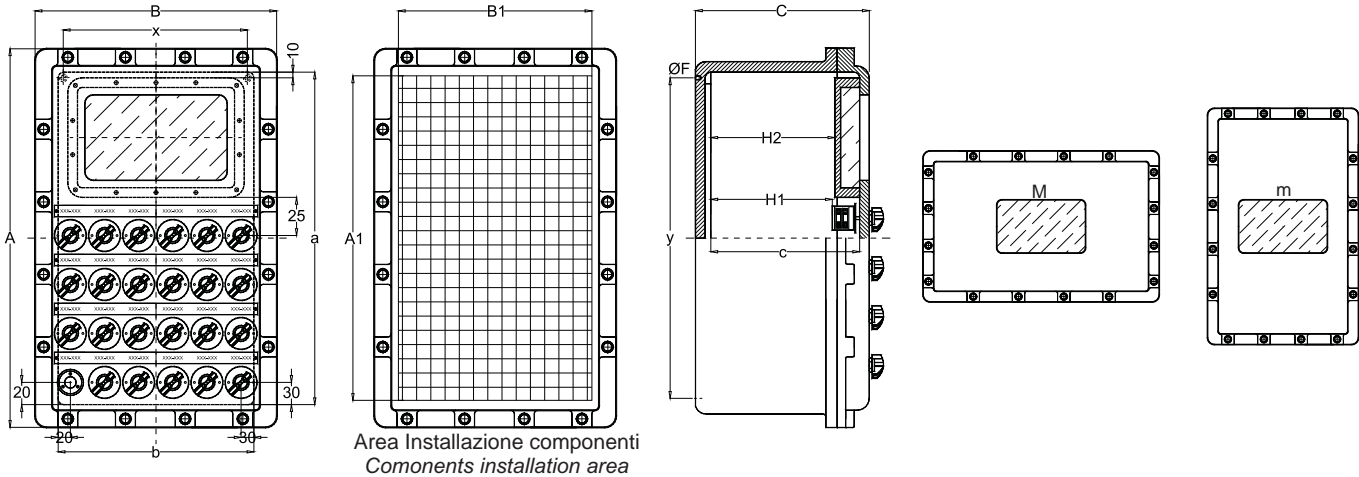

Codice/Code	F55	F105	F155	F205	F255	F1010	F1510	F1515	F2010	F2510	F2015	F2515	F90
Finestra/Window	50x50	100x50	150x50	200x50	250x50	100x100	150x100	150x150	200x100	250x100	200x150	250x150	Ø90
EJB 544A	M —	—	—	—	—	—	—	—	—	—	—	—	•
EJB 755A	M •	—	—	—	—	—	—	—	—	—	—	—	•
EJB 1076A	M •	•	•	—	—	—	—	—	—	—	—	—	•
EJB 1286A	M •	•	•	•	—	•	•	—	•	—	—	—	•
EJB 14107A	M •	•	•	•	•	•	•	•	•	•	•	•	•
EJB 17129BA	M •	•	•	•	—	•	•	•	•	—	•	—	•
EJB 17129A	M •	•	•	•	—	•	•	•	•	—	•	—	•
EJB 221410A	M •	•	•	•	•	•	•	•	•	•	•	•	•

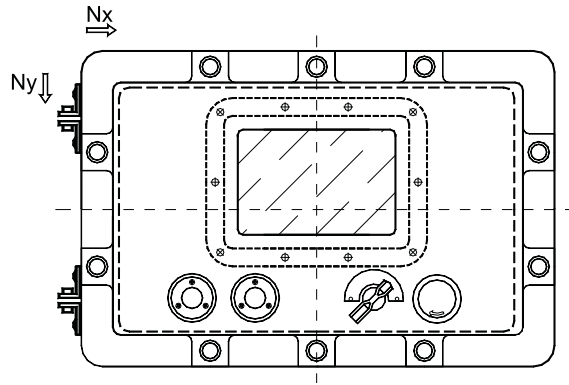

Codice/Code			F55	F105	F155	F205	F255	F1010	F1510	F1515	F2010	F2510	F2015	F2515	F90
Finestra/Window			50x50	100x50	150x50	200x50	250x50	100x100	150x100	150x150	200x100	250x100	200x150	250x150	ø90
EJB 544..A	M	Nx Ny	- 0	- 0	- 0	- 0	- 0	- 0	- 0	- 0	- 0	- 0	- 0	- 0	0
	m	Nx Ny	- 0	- 0	- 0	- 0	- 0	- 0	- 0	- 0	- 0	- 0	- 0	- 0	0
EJB 755..A	M	Nx Ny	• 0	- 0	- 0	- 0	- 0	- 0	- 0	- 0	- 0	- 0	- 0	- 0	0
	m	Nx Ny	• 0	- 0	- 0	- 0	- 0	- 0	- 0	- 0	- 0	- 0	- 0	- 0	0
EJB 1076A	M	Nx Ny	• 0	• 0	• 0	- 0	- 0	- 0	- 0	- 0	- 0	- 0	- 0	- 0	0
	m	Nx Ny	• 2	- 0	- 0	- 0	- 0	- 0	- 0	- 0	- 0	- 0	- 0	- 0	2
EJB 1286A	M	Nx Ny	• 5	• 5	• 5	• 5	- 0	• 0	• 0	- 0	• 0	- 6	- 0	- 0	5
	m	Nx Ny	• 3	• 3	- 0	- 0	- 0	• 3	- 0	- 0	- 0	- 0	- 0	- 0	3
EJB 14107A	M	Nx Ny	• 6	• 6	• 6	• 6	• 6	• 6	• 6	• 0	• 6	• 6	• 0	• 0	6
	m	Nx Ny	• 4	• 4	• 4	- 0	- 0	• 4	• 4	• 4	- 0	- 0	- 0	- 0	4
EJB 17129..A	M	Nx Ny	• 8	• 8	• 8	• 8	• 8	• 8	• 8	• 8	• 8	• 8	• 8	• 8	8
	m	Nx Ny	• 5	• 5	• 5	• 5	- 0	• 5	• 5	• 0	• 5	- 5	• 5	- 5	5
EJB 221410A	M	Nx Ny	• 10	• 10	• 10	• 10	• 10	• 10	• 10	• 10	• 10	• 10	• 10	• 10	10
	m	Nx Ny	• 5	• 5	• 5	• 5	• 5	• 5	• 5	• 5	• 5	• 5	• 5	• 5	5





GAS	II2G Ex d IIB+H₂ T6 ÷ T5	* IP65/IP66	Zone 1 - Zone 21 - Zone 2 - Zone 22	
DUST	II2D Ex tD A21 T80°C ÷ T95°C	* IP65/IP66	❄️-20°C ÷ ☀️+40°C	❄️-20°C ÷ ☀️+60°C

Materiale : Corpo e coperchio di lega leggera
 Installazione : con staffe in acciaio zincato a richiesta
 Viteria : Acciaio zincato a richiesta inox
 Guarnizioni : a richiesta al silicone per IP 66
 Ingresso : vedi tabella

Material : *Light alloy cover and body*
 Installation : *Galvanized steel lugs on demand*
 Hardware : *galvanized steel or stainless steel*
 Gaskets : *on demand silicon for IP 66*
 Cable entry : *see table*

* IP65 con grasso al silicone - IP66 con guarnizione
 IP65 with silicon grease - IP66 with silicon gasket

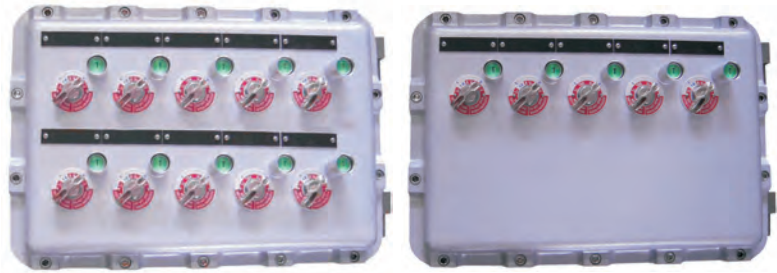

N° massimo di interruttori magnetotermici
Maximum number of circuit breakers

Codice Code	N° massimo di interruttori magnetotermici Maximum number of circuit breakers			N° massimo di interruttori magnetotermici con differenziale Max. number of circuit breakers with residual current device		
	2 POLI 2 POLES	3 POLI 3 POLES	4 POLI 4 POLES	2 POLI 2 POLES	3 POLI 3 POLES	4 POLI 4 POLES
EJB 755..A	1 (63A)	1 (63A)	1 (63A)	1 (63A)	—	—
EJB 1076A	1 (63A)	1 (63A)	1 (63A)	1 (63A)	1 (63A)	1 (63A)
EJB 1286A	3 (25A)	3 (25A)	3 (25A)	3 (25A)	2 (25A)	2 (25A)
EJB 14107A	8 (25A)	5 (25A)	5 (25A)	4 (25A)	4 (25A)	2 (25A)
EJB 17129..A	14 (25A)	12 (25A)	10 (25A)	10 (25A)	6 (25A)	6 (25A)
EJB 221410A	18 (25A)	16 (25A)	12 (25A)	12 (25A)	8 (25A)	8 (25A)

Morsettiera sul fondo
Terminals installed on the bottom

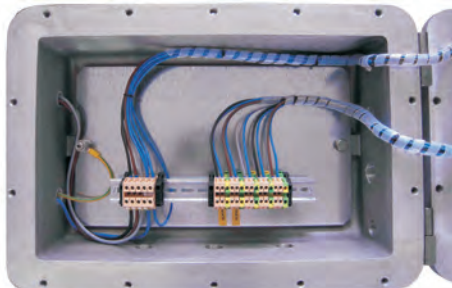

Manovra rotativa e pulsante test
Rotative mechanical drive and test button

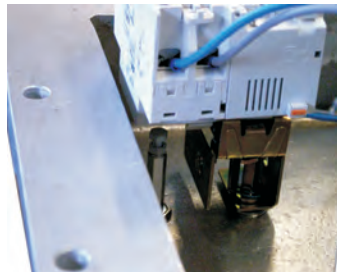

Magnetotermici installati a retro coperchio
Circuit breakers installed on the rear of the cover

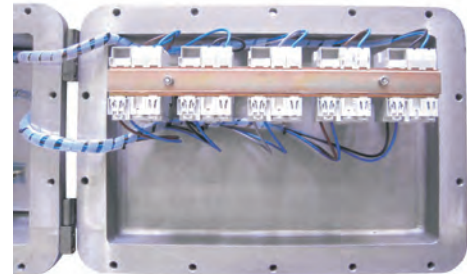

GAS	II2G Ex d IIB+H₂ T6 ÷ T5	* IP65/IP66	Zone 1 - Zone 21 - Zone 2 - Zone 22	
DUST	II2D Ex tD A21 T80°C ÷ T95°C	* IP65/IP66	❄️-20°C ÷ ☀️+40°C	❄️-20°C ÷ ☀️+60°C



Codice Code	Corrente Current [A]	Potenza Rated power kW @ 230V	Potenza Rated power kW @ 400V	Codice Code	Corrente Current [A]	Potenza Rated power kW @ 230V	Potenza Rated power kW @ 400V
EJB 544CM01	0,10 ÷ 0,16	-	-	EJB 544CM10	4,0 ÷ 6,3	1,10	2,20
EJB 544CM02	0,16 ÷ 0,25	-	0,06	EJB 544CM14	6,0 ÷ 10	2,20	3,00
EJB 544CM03	0,25 ÷ 0,4	0,06	0,09	EJB 544CM16	9,0 ÷ 14	3,00	5,50
EJB 544CM04	0,40 ÷ 0,63	-	0,12	EJB 544CM20	13 ÷ 18	4,00	7,50
EJB 544CM05	0,63 ÷ 1,0	-	0,25	EJB 544CM21	17 ÷ 23	5,50	9,00
EJB 544CM06	1,0 ÷ 1,6	0,25	0,37	EJB 544CM22	20 ÷ 25	6,00	11,0
EJB 544CM07	1,6 ÷ 2,5	0,37	0,75	EJB 544CM32	24 ÷ 32	7,50	15,0
EJB 544CM08	2,5 ÷ 4,0	0,75	1,10				



GAS	II2G Ex d IIB / Ex d IIB+H2 T6	*IP65/IP66	Zone 1 - Zone 21 - Zone 2 - Zone 22
DUST	II2D Ex tD A21 T80°C	*IP65/IP66	❄️-20°C ÷ ☀️+40°C ❄️-20°C ÷ ☀️+60°C

Materiale : Corpo e coperchio di lega leggera
Installazione : con staffe in acciaio zincato a richiesta
Viteria : Acciaio zincato a richiesta inox
Guarnizioni : a richiesta al silicone per IP 66
Ingresso : vedi tabella

Material : Light alloy cover and body
Installation : Galvanized steel lugs on demand
Hardware : galvanized steel or stainless steel
Gaskets : on demand silicon for IP 66
Cable entry : see table

* IP65 con grasso al silicone - IP66 con guarnizione
 IP65 with silicon grease - IP66 with silicon gasket

Tensione alimentazione : 230 V - 50/60Hz
Corrente nominale : 28 mA
Circuito ausiliario (1NO+1NC) : 5 A @ 250 V
Fattore di potenza : 0,8
Peso : 14 kg

Auxiliary circuit (1NO+1NC) : 5 A @ 250 V
Input voltage : 230 V - 50/60Hz
Rated current : 28 mA
Power factor : 0,8
Weight : 14 kg

Caratteristiche :

Il dispositivo, mediante il collegamento della pinza a parti conduttrici dell'autobotte, consente di disperdere verso terra le cariche elettrostatiche generate durante le operazioni di carico e scarico. L'unità elettronica verifica le condizioni di resistenza e, se idonee, abilita la messa a terra e la commutazione del contatto di scambio che pilota la pompa dell'autobotte, segnalata dalla accensione della spia verde.

Features :

The apparatus, by means of the clamp connected to conductive parts of tank truck, disperses to the ground the electrostatic charges generated during load and unload operations. The electronic unit of the apparatus verify the ground resistance, and if it's acceptable, allow round connection and it switches the SPDT contacts which enable/disable the pump of tanker and it is signaled by green light.

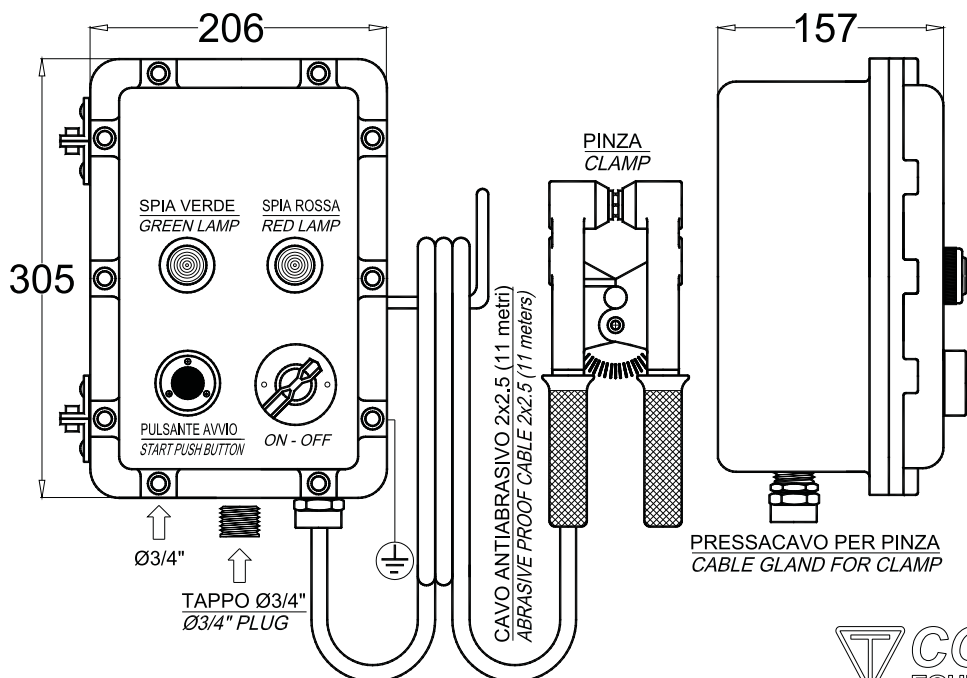

F10

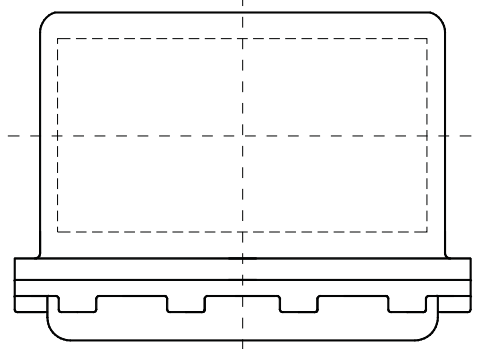
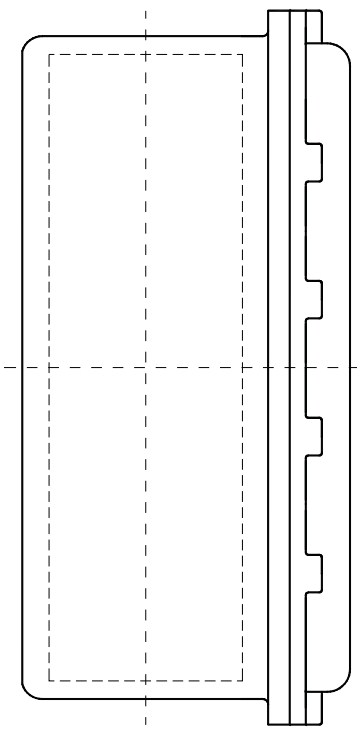
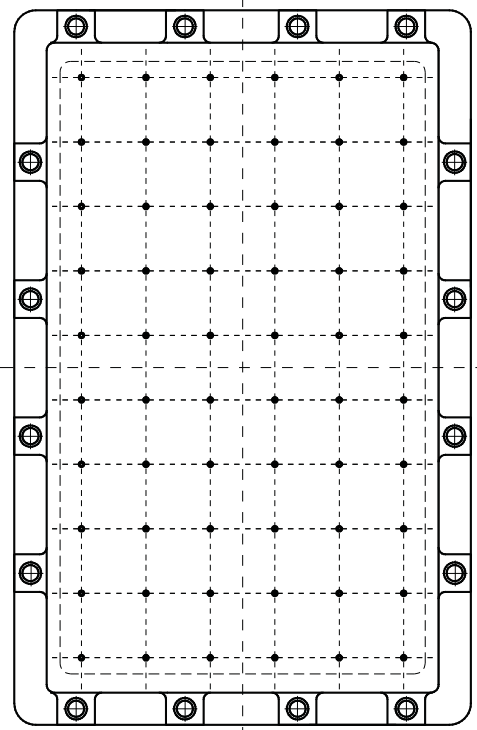
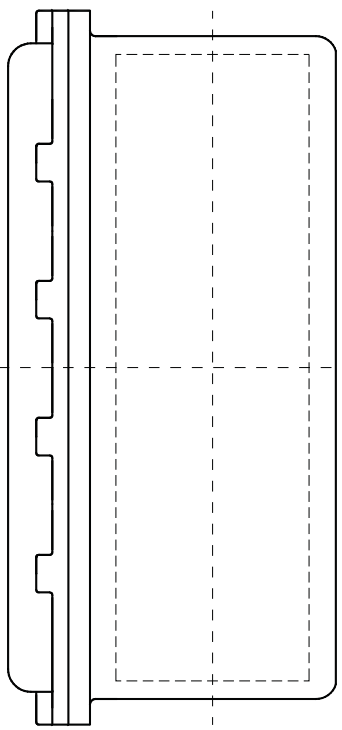
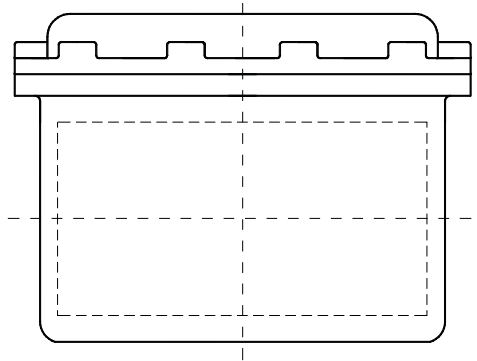



CO.SIME.

EQUIPMENT FOR ATEX





GAS	II2G Ex d IIC T6 ÷ T4	IP66	Zone 1 - Zone 21 - Zone 2 - Zone 22
DUST	II2D Ex tD A21 T80°C ÷ T130°C	IP66	❄️-20°C ÷ ☀️+40°C ❄️-20°C + ☀️+60°C

Materiale : Corpo e coperchio di lega leggera
 Installazione : con piedi di fissaggio

Guarnizioni : EPDM, a richiesta al silicone per IP 66
 Ingresso : vedi tabella

Material : *Light alloy cover and body*
 Installation : *with lugs*

Gaskets : *EPDM, on demand silicon for IP 66*
 Cable entry : *see table*



Codice Code	ØA	B	C	D	E	Øa1	Øa2	b1	b2	c	x	y	ØF	Piastra Frame	G	H	Peso Weight [kg]
GUB 20	110	119	144	144	195	97	88	70	95	116	108	169	9	PF 20	90	85	2,300
GUB 30	150	142	174	165	214	135	125	74	112	140	136	190	11	PF 54	123	85	4,000
GUB 40	194	163	252	213	284	175	161	90	127	215	206	248	13	PF 75	156	105	7,000
GUB 50B	264	185	305	280	360	240	223	100	147	272	265	320	13	PF 107	233	130	13,400
GUB 50	264	221	305	280	360	240	223	125	167	272	265	320	13	PF 107	233	130	15,700

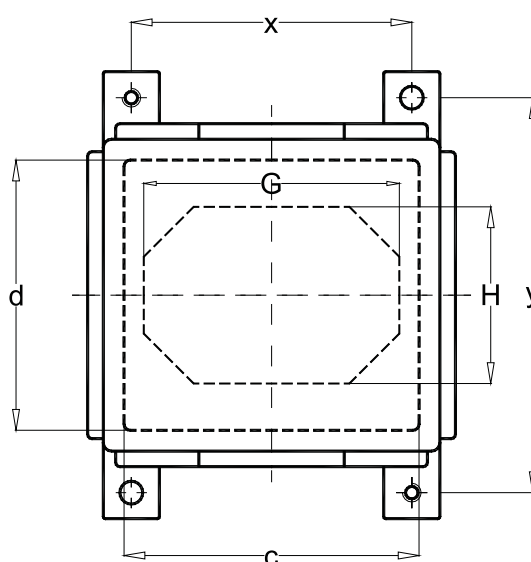
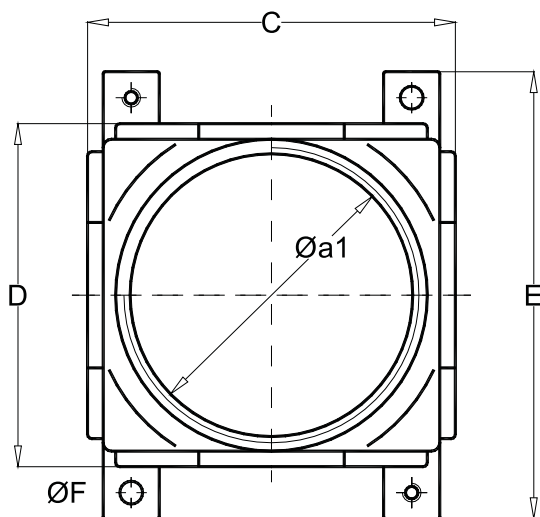
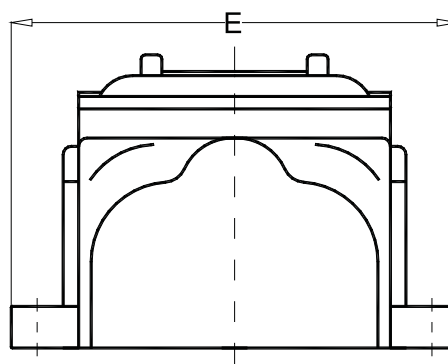
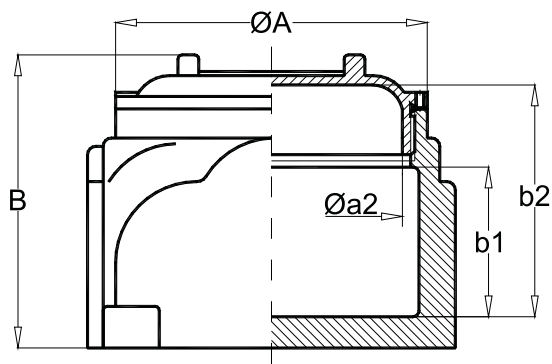



SCHEMA DI FORATURA PER INGRESSO CON RACCORDO A TRE PEZZI E GIUNTO DI BLOCCAGGIO DRILL ARRANGEMENT FOR ENTRY BY UNION AND SEALED JOINT											
Codice/Code	schema arrangement	lato side	1/2" M20x1.5	3/4" M25x1.5	1" M32x1.5	1 1/4" M40x1.5	1 1/2" M50x1.5	2" M63x1.5	2 1/2" M75x1.5	3" M90x1.5	4"
GUB 20	libero free	maggiore - major minore - minor	3 2	2 2	2 1	1 1	1 1	- -	- -	- -	- -
GUB 30	libero free	maggiore - major minore - minor	3 3	3 3	2 2	2 2	2 1	1 1	- -	- -	- -
GUB 40	libero free	maggiore - major minore - minor	5 4	4 3	3 3	3 2	3 2	2 2	1 1	- -	- -
GUB 50B	libero free	maggiore - major minore - minor	7 6	6 5	5 4	4 3	4 3	3 3	- -	- -	- -
GUB 50	libero free	maggiore - major minore - minor	7 6	6 5	5 4	4 3	4 3	3 3	2 2	2 2	1 1

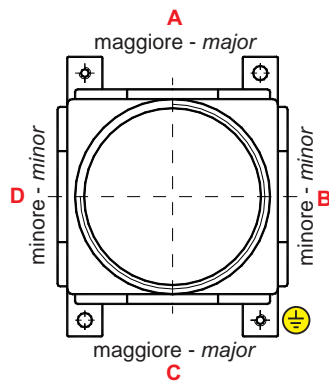

IMBOCCO - HUB Gk									
Codice - Code	1	2	3	4	5	6	7	8	9
Gk	1/2	3/4	1	1 1/4	1 1/2	2	2 1/2	3	4

IMBOCCO-HUB METRICAL x 1.5									
Codice - Code	16	20	25	32	40	50	63	75	90
Metrical	M16	M20	M25	M32	M40	M50	M63	M75	M90

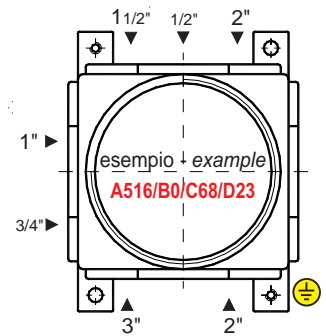

SCHEMA DI FORATURA PER INGRESSO CON PRESSACAVO DRILL ARRANGEMENT FOR ENTRY BY CABLE GLAND											
Codice/Code	schema arrangement	lato side	1/2" M20x1.5	3/4" M25x1.5	1" M32x1.5	1 1/4" M40x1.5	1 1/2" M50x1.5	2" M63x1.5	2 1/2" M75x1.5	3" M90x1.5	4"
GUB 20	libero free	minore - minor maggiore - major	3 2	2 2	2 1	1 1	1 1	- -	- -	- -	- -
GUB 30	libero free	minore - minor maggiore - major	4 4	3 3	2 2	2 2	2 2	1 1	- -	- -	- -
GUB 40	libero free	minore - minor maggiore - major	6 4	4 3	3 3	3 2	3 2	2 2	1 1	- -	- -
GUB 50B	libero free	minore - minor maggiore - major	11 10	9 8	7 6	4 3	3 3	3 3	- -	- -	- -
GUB 50	libero free	minore - minor maggiore - major	12 10	10 8	8 6	5 4	4 4	3 3	2 2	2 2	1 1



GAS	II2G Ex d IIC T6 ÷ T4	IP66	Zone 1 - Zone 21 - Zone 2 - Zone 22
DUST	II2D Ex tD A21 T80°C ÷ T130°C	Ip66	❄️-20°C ÷ ☀️+40°C ❄️-20°C + ☀️+60°C

Codice/Code	Corrente Current [A]	Potenza max. dissipabile Max. power dissipable [W]	Classe temp. Temp. class @ +40°C	Max. temp superfic. Max. surface temp @ +40°C	Classe di temp. Temp. class @ +60°C	Max. temp superfic. Max. surface temp @ +60°C
GUB 20	63	17	T6	T 80°C	T5	T 95°C
GUB 30	160	25	T6	T 80°C	T5	T 95°C
GUB 40	250	40	T6	T 80°C	T5	T 95°C
GUB 50B	400	55	T6	T 80°C	T5	T 95°C
GUB 50	400	70	T6	T 80°C	T5	T 95°C
SF 29	125	15	T6	T 80°C	T5	T 95°C
SF 240	200	22	T6	T 80°C	T5	T 95°C
S□□4	16	7	T6	T 80°C	T5	T 95°C
S□□6	25	9	T6	T 80°C	T5	T 95°C
S□□7	40	15	T6	T 80°C	T5	T 95°C
S□□9	125	19	T6	T 80°C	T5	T 95°C

Codice/Code	Corrente Current [A]	Potenza max. dissipabile Max. power dissipable [W]	Classe temp. Temp. class @ +40°C	Max. temp superfic. Max. surface temp @ +40°C	Classe di temp. Temp. class @ +60°C	Max. temp superfic. Max. surface temp @ +60°C
GUB 20	63	40	T5	T 95°C	T4	T 130°C
GUB 30	160	55	T5	T 95°C	T4	T 130°C
GUB 40	250	85	T5	T 95°C	T4	T 130°C
GUB 50B	400	120	T5	T 95°C	T4	T 130°C
GUB 50	400	150	T5	T 95°C	T4	T 130°C
SF 29	125	35	T5	T 95°C	T4	T 130°C
SF 240	200	50	T5	T 95°C	T4	T 130°C
S□□9	125	35	T5	T 95°C	T4	T 130°C



Materiale:	Poliammide
Tensione nominale:	MCBD 2 - 690 [V] MCBD 4 + MCBD 70 - 1000 [V]
Materiale:	Polyammide
Rated voltage:	MCBD 2 - 690 [V] MCBD 4 + MCBD 70 - 1000 [V]

Codice/Code CO.SI.ME.	Codice/Code CABUR	Sect. nom. [mm ²]	[mm ²] min	[mm ²] max	Current [A]
MCBD 2	CBD 2	2.5	0.5	4	29
MCBD 4	CBD 4	4	0.5	6	40
MCBD 6	CBD 6	6	0.5	10	58
MCBD 10	CBD 10	10	0.5	16	77
MCBD 16	CBD 16	16	0.5	25	104
MCBD 35	CBD 35	35	0.5	50	147
MCBD 50	CBD 50	50	1.5	70	180
MCBD 70	CBD 70	70	1.5	95	250

Sezione morsetto [mm²] - Terminal section [mm²]

Codice/Code	2.5	4	6	10	16	35	50	70
GUB 20	13	10	8	6	5	-	-	-
GUB 30	20	17	13	11	9	6	5	5
GUB 40	27	23	19	15	12	9	8	7
GUB 50B	40	33	27	21	18	13	12	10
GUB 50	40	33	27	21	28	13	12	10



GAS	II2G Ex d IIC T6 ÷ T4	IP66	Zone 1 - Zone 21 - Zone 2 - Zone 22
DUST	II2D Ex tD A21 T80°C ÷ T130°C	IP66	❄️-20°C ÷ ☀️+40°C ❄️-20°C ÷ ☀️+60°C

Materiale : Corpo e coperchio di lega leggera
 Installazione : a richiesta con staffe in acciaio zincato e a richiesta inox (Fig. A)
 Guarnizioni : EPDM, a richiesta al silicone per IP 66
 Ingresso : vedi tabella

Material : *Light alloy cover and body*
 Installation : *on demand galvanized steel lugs and on demand stainless steel (Fig. A)*
 Gaskets : *EPDM, on demand silicon for IP 66*
 Cable entry : *see table*



Infilaggio Code pull box	Derivazione Code junction	Imb. Size	ØA ØA	Installaz. Installation	C [g] peso weight	B [g] peso weight	D [g] peso weight	G [g] peso weight	L [g] peso weight	M [g] peso weight	T [g] peso weight	FT [g] peso weight	W [g] peso weight	FW [g] peso weight	X [g] peso weight	XB [g] peso weight
SJ.. 14	S.. 14	½"	70	conduit	244	244	268	--	244	268	268	--	286	--	286	--
SJ.. 24	S.. 24	¾"	70	conduit	264	264	298	--	264	298	298	--	334	--	334	--
SJ.. 26	S.. 26	¾"	90	Fig. A	330	330	355	490	330	355	355	--	355	--	380	440
SJF.. 26	SF.. 26	¾"	90	Fig. B	--	--	--	--	--	--	--	580	--	630	--	--
SJ.. 36	S.. 36	1"	90	Fig. A	410	410	440	--	410	--	410	--	--	--	440	--
SJ.. 29	S.. 29	¾"	150	Fig. C	1400	1400	1450	--	1400	--	1450	--	--	--	1540	--
SJ.. 39	S.. 39	1"	150	Fig. C	1390	1390	1380	--	1390	--	1380	--	--	--	1600	--
SJ.. 59	S.. 59	1½"	150	Fig. C	1420	1420	1450	--	1420	--	1450	--	--	--	1490	--
SJ.. 69	S.. 69	2"	150	Fig. C	1400	1400	1300	--	1400	--	1300	--	--	--	1300	--

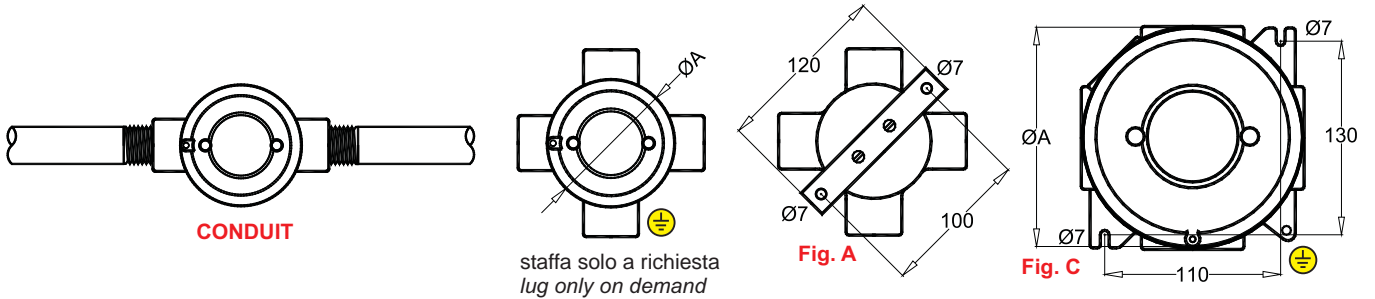

L	T	C	X	B	D	M	W	XB
2 vie 2 way	3 vie 3 way	2 vie 2 way	4 vie 4 way	2 vie 2 way	3 vie 3 way	3 vie 3 way	4 vie 4 way	5 vie 5 way

SFT	SFW	SG
3 vie 3 way	4 vie 4 way	3 vie 3 way

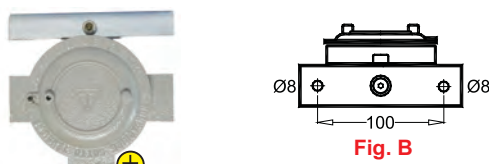

EX	GAS	II2G Ex d IIC T6 ÷ T4	IP66	Zone 1 - Zone 21 - Zone 2 - Zone 22	
	DUST	II2D Ex tD A21 T80°C ÷ T130°C	IP66	❄️-20°C ÷ ☀️+40°C	❄️-20°C + ☀️+60°C

Materiale : Poliammide

Tensione nominale : MRN 2 - 400 [V]
MRP 4 - 630 [V]
MCBD 2 - 690 [V]
MCBD 4 ÷ MCBD 70 - 1000 [V]
MM 46 - 800 [V]

Material : Polyamide

Rated voltage : MRN 2 - 400 [V]
MRP 4 - 630 [V]
MCBD 2 - 690 [V]
MCBD 4 ÷ MCBD 70 - 1000 [V]
MM 46 - 800 [V]



Codice/Code CO.SI.ME.	Codice/Code CABUR	Sect. nom.	[mm ²] min	[mm ²] max	Current [A]
MRN 2	RN 2	2.5	0.2	4	24
MRP 4	RP 4	4	0.2	6	32
MCBD 2	CBD 2	2.5	0.5	4	29
MCBD 4	CBD 4	4	0.5	6	40
MCBD 6	CBD 6	6	0.5	10	58
MM 46	--	6	0.5	6	40
MCBD 10	CBD 10	10	0.5	16	77
MCBD 16	CBD 16	16	0.5	25	104
MCBD 35	CBD 35	35	0.5	50	147
MCBD 50	CBD 50	50	1.5	70	180
MCBD 70	CBD 70	70	1.5	95	250

Codice/Code	Sezione morsetto [mm ²] - Terminal section [mm ²]								
	2.5	4	6	6	10	16	35	50	70
S.. 26	6 (MRN 2)	5 (MRP 4)	4x6 (MM 46)	-	-	-	-	-	-
S.. 36	6 (MRN 2)	5 (MRP 4)	4x6 (MM 46)	-	-	-	-	-	-
S.. 29	20	17	-	13	11	9	6	5	5

EX	GAS	II2G Ex d IIC T6 ÷ T4	IP66	Zone 1 - Zone 21 - Zone 2 - Zone 22	
	DUST	II2D Ex tD A21 T80°C ÷ T130°C	IP66	❄️-20°C ÷ ☀️+40°C	❄️-20°C + ☀️+60°C

Materiale : Corpo e coperchio di lega leggera
Guarnizioni : EPDM, a richiesta al silicone per IP 66
Ingresso : vedi tabella

Material : Light alloy cover and body
Gaskets : EPDM, on demand silicon for IP 66
Cable entry : see table



Codice Code (Gk)	Codice Code (NPT)	A	B	C
SB 116	SB 116N	Ø ½	Ø ½	-
SB 216	SB 216N	Ø ¾	Ø ½	-
SD 116	SD 116N	Ø ½	Ø ½	Ø ½
SD 216	SD 216N	Ø ¾	Ø ½	Ø ¾
SD 226	SD 226N	Ø ¾	Ø ¾	Ø ¾

EX	GAS	II2G Ex d IIC T6 ÷ T4	IP66	Zone 1 - Zone 21 - Zone 2 - Zone 22	
	DUST	II2D Ex tD A21 T80°C ÷ T130°C	IP66	❄️-20°C ÷ ☀️+40°C	❄️-20°C + ☀️+60°C

Materiale : Corpo e coperchio di lega leggera
Guarnizioni : EPDM, a richiesta al silicone per IP 66
Ingresso : vedi tabella

Material : Light alloy cover and body
Gaskets : EPDM, on demand silicon for IP 66
Cable entry : see table

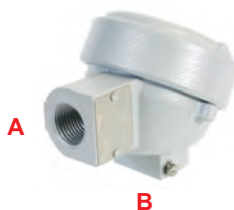

Codice Code (Gk)	Codice Code (NPT)	A	B
GUJP 11	GUJP 11N	Ø ½	Ø ½
GUJP 21	GUJP 21N	Ø ½	Ø ¾
GUJP 22	GUJP 22N	--	--
GUJP 12	GUJP 12N	--	--



GAS	II2G Ex d IIC T5 ÷ T2	IP 66	Zone 1 - Zone 21 - Zone 2 - Zone 22
DUST	II2D Ex tD A21 T95°C ÷ T295°C	IP 66	❄️-20°C ÷ ☀️+40°C ❄️-20°C ÷ ☀️+80°C

Materiale : corpo : lega leggera
trasparente : vetro borosilicato
portalampane : ceramico

Installazione : varie (vedi dettagli)

Viteria : Acciaio inox AISI 304

Guarnizioni : +40°C EPDM , +60°C Silicone

Collegamento : Morsettiera portalampane

Ingresso : N° 1 ø3/4" (EVA 80÷250) - ø1" (EVA 400)

Peso : 1,5 ÷ 6,5 kg

Material : body : light alloy
transparent : borosilicate glass
lamp holder : ceramic

Installation : various (see details)

Hardware : Stainless steel AISI 304

Gaskets : +40°C EPDM , +60°C Silicon

Connection : on lamp holder

Cable entry : N° 1 ø3/4" (EVA 80+250) - ø1" (EVA 400)

Weight : 1,5 ÷ 6,5 kg

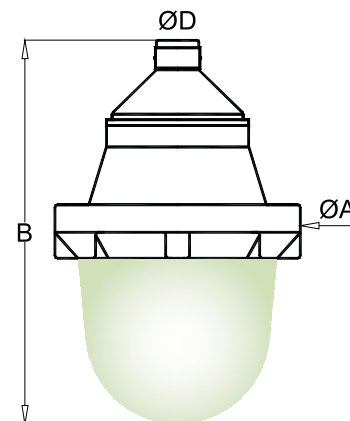

Potenza : Vedi tabella

Tensione : 230V a richiesta altre tensioni

Frequenza : 50Hz ÷ 60Hz

Morsettiera : 2,5mm²

Power : See table

Voltage : 230V other voltages on request

Frequency : 50Hz + 60Hz

Terminals : 2,5mm²

Codice / Code	ØA	B	ØC	ØD	max [W]	[kg]
EVA 50	128	222	218	3/4"	100	1,5
EVA 80	146	264	280	3/4"	150	2,2
EVA 125	174	294	300	3/4"	200	4,5
EVA 250	196	375	336	3/4"	300	5,0
EVA 400	259	416	450	1"	500	6,5

Codice Code	Potenza Power	Attacco Cap	Temp class @+40°C	Temp class @+60°C	Temp class @+80°C	Peso Weight
Incandescenza - alogene - led - fluorescenti / Incandescent - halogen - led - fluorescent						
EV.. 50	75 W - 100 W	E27	T5-T4	T4-T4	T4-T3	
EV.. 80	150 W	E27	T4	T4	T3	
EV.. 125	200 W	E27	T4	T3	T3	
EV.. 250	300 W	E40	T3	T3	T3	
EV.. 400	500 W	E40	T3	T3	T2	
Vapori di mercurio / Mercury vapour						
EW.. 80RHg	80 W	E27	T4	T4	-	
EW.. 125RHg	125 W	E27	T4	T4	-	
EW.. 250RHg	250 W	E40	T3	T3	-	
EW.. 400RHg	400 W	E40	T3	T3	-	
Ioduri metallici / Metal halide						
EW.. 100RMH	100 W	E27	T3	T4	-	
EW.. 150RMH	150 W	E27	T3	T3	-	
EW.. 250RMH	250 W (2,15A)	E40	T3	T3	-	
EW.. 400RMH	400 W (3,25A)	E40	T3	T3	-	
Sodio alta pressione / high pressure sodium						
EW.. 70RNa	70 W	E27	T3	T4	-	
EW.. 150RNa	150 W	E27	T3	T3	-	
EW.. 250RNa	250 W	E40	T3	T3	-	
EW.. 400RNa	400 W	E40	T3	T3	-	



GAS	II2G Ex d IIC T5 ÷ T2	IP 66	Zone 1 - Zone 21 - Zone 2 - Zone 22
DUST	II2D Ex tD A21 T95°C ÷ T295°C	IP 66	❄️-20°C ÷ ☀️+40°C ❄️-20°C ÷ ☀️+60°C



Codice Code	[Vac]	Codice Code	[Vac/dc]	Colore Color	Funzione Function	EVA EVA	Lamp led Led tower	[W]	[kg]
EV ..TL0..FA110230 EV ..TL0..FB110230 EV ..TL0..FG110230 EV ..TL0..FR110230 EV ..TL0..FV110230	110÷230	EV ..TL0..FA12-24-48 EV ..TL0..FB12-24-48 EV ..TL0..FG12-24-48 EV ..TL0..FR12-24-48 EV ..TL0..FV12-24-48	12-24-48	blu- blue bianco - white giallo - yellow rosso - red verde - green	luce fissa steady light	EVA 50 EVA 80 EVA 80 EVA 80 EVA 125	60 led 80 led 100 led 120 led 180 led	5÷6 6÷7 7÷8 8÷9 12÷15	
EV ..TL0..LA110230 EV ..TL0..LB110230 EV ..TL0..LG110230 EV ..TL0..LR110230 EV ..TL0..LV110230	110÷230	EV ..TL0..LA12-24-48 EV ..TL0..LB12-24-48 EV ..TL0..LG12-24-48 EV ..TL0..LR12-24-48 EV ..TL0..LV12-24-48	12-24-48	blu- blue bianco - white giallo - yellow rosso - red verde - green	luce lamp. flashing light	EVA 50 EVA 80 EVA 80 EVA 80 EVA 125	60 led 80 led 100 led 120 led 180 led	5÷6 6÷7 7-8 8÷9 12÷15	
EV ..TL0..RA110230 EV ..TL0..RB110230 EV ..TL0..RG110230 EV ..TL0..RR110230 EV ..TL0..RV110230	110÷230	EV ..TL0..RA12-24-48 EV ..TL0..RB12-24-48 EV ..TL0..RG12-24-48 EV ..TL0..RR12-24-48 EV ..TL0..RV12-24-48	12-24-48	blu- blue bianco - white giallo - yellow rosso - red verde - green	luce rotante rotating light	EVA 50 EVA 80 EVA 80 EVA 80 EVA 125	60 led 80 led 100 led 120 led 180 led	5÷6 6÷7 7÷8 8÷9 12÷15	

esempio : EV 80TL100RG24 : lampada tower led a N° 100 led 24Vac/dc luce gialla rotante
sample : EV 80TL100RG24 : tower led lamp with N° 100 led 24Vac/dc rotating yellow light



Codice Code	[Vac]	Codice Code	[Vac/dc]	Xenon Xenon	Colore Color	Funzione Function	EVA EVA	[W]	[kg]
EV 50LAX110-230 EV 50LBX110-230 EV 50LGX110-230 EV 50LRX110-230 EV 50LVX110-230	110-230	EV 50LAX12-24-48 EV 50LBX12-24-48 EV 50LGX12-24-48 EV 50LRX12-24-48 EV 50LVX12-24-48	12-24-48	6 JOULE	blu- blue giallo - yellow rosso - red verde - green	luce lamp. flashing light	EVA 50	10	
EV 125LAX110-230 EV 125LBX110-230 EV 125LGX110-230 EV 125LRX110-230 EV 125LVX110-230	110-230	EV 125LAX12-24-48 EV 125LBX12-24-48 EV 125LGX12-24-48 EV 125LRX12-24-48 EV 125LVX12-24-48	12-24-48	16 JOULE	blu- blue giallo - yellow rosso - red verde - green	luce lamp. flashing light	EVA 125	20	

esempio : EV 50LRX230 : lampada flash 6 joule luce rossa 230Vac
sample : EV 50LRX230 : flash lamp 6 joule red light 230Vac



GAS	II2G Ex d IIC T5 ÷ T4	IP 66	Zone 1 - Zone 21 - Zone 2 - Zone 22
DUST	II2D Ex tD A21 T95°C ÷ T130°C	IP 66	❄️ -20°C ÷ ☀️ +40°C ❄️ -20°C ÷ ☀️ +80°C

Materiale : corpo : lega leggera
trasparente : vetro borosilicato
globo fresnel in policarbonato (norme ICAO)
portalampane : ceramico

Installazione : varie (vedi dettagli)

Viteria : Acciaio inox AISI 304 - Staffe in acciaio zincato

Guarnizioni : +40°C EPDM , +60°C Silicone

Morsettiera : 4 mm²

Potenza : Vedi tabella

Ingresso : N° 1 ø3/4"

Material : body : light alloy
transparent : borosilicate glass
lamp holder : ceramic
Fresnel polycarbonate globe (ICAO standard)

Installation : various (see details)

Hardware : Stainless steel AISI 304 - Galvanized steel lugs

Gaskets : +40°C EPDM , +60°C Silicon

Terminals : 4 mm²

Power : See table

Cable entry : N° 1 ø3/4"

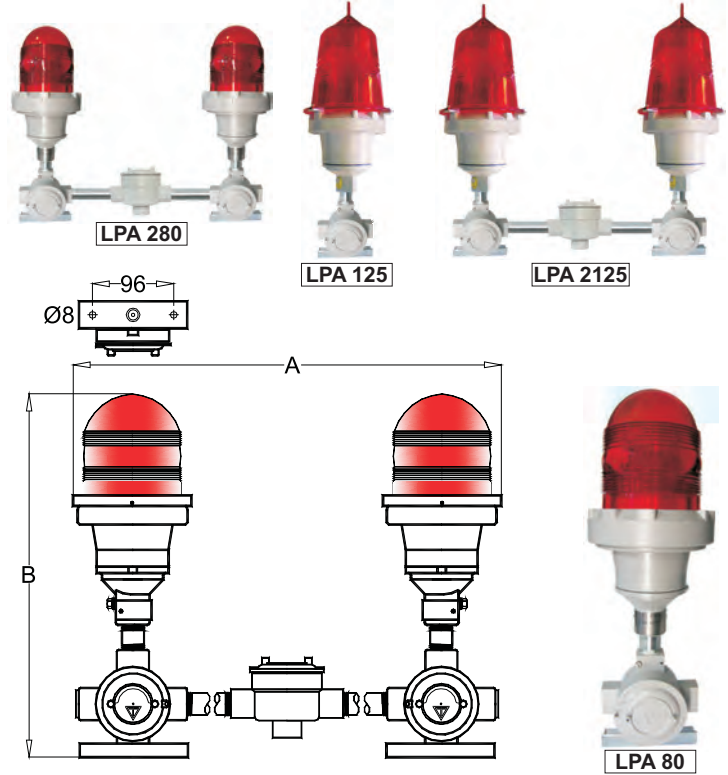

Codice / Code	EVA	ØA	B	[kg]
LPA 80	1 x EVA 50	128	430	3,0
LPA 280	2 x EVA 50	540	430	6,5
LPA 125	1 x EVA 125	174	560	5,5
LPA 2125	2 x EVA 125	590	560	12,0

	Codice Code	[Vac]	Codice Code	[Vac/dc]	Colore Color	Funzione Function	EVA EVA	Lamp led Led tower	[W]				
	TOWER LED	EV ..TL0..FA110230 EV ..TL0..FB110230 EV ..TL0..FG110230 EV ..TL0..FR110230 EV ..TL0..FV110230	110+230 50+60Hz	EV ..TL0..FA12-24 EV ..TL0..FB12-24 EV ..TL0..FG12-24 EV ..TL0..FR12-24 EV ..TL0..FV12-24	12-24-48	blu- blue bianco - white giallo - yellow rosso - red verde - green	luce fissa steady light	EVA 50 EVA 125 EVA 125 EVA 125 EVA 125	60 led 80 led 100 led 120 led 180 led	5+6 6+7 7+8 8+9 12+15			
EV ..TL0..LA110230 EV ..TL0..LB110230 EV ..TL0..LG110230 EV ..TL0..LR110230 EV ..TL0..LV110230		110+230 50+60Hz		EV ..TL0..LA12-24 EV ..TL0..LB12-24 EV ..TL0..LG12-24 EV ..TL0..LR12-24 EV ..TL0..LV12-24		12-24-48	blu- blue bianco - white giallo - yellow rosso - red verde - green	luce lamp. flashing light	EVA 50 EVA 125 EVA 125 EVA 125 EVA 125	60 led 80 led 100 led 120 led 180 led	5+6 6+7 7+8 8+9 12+15		
EV ..TL0..RA110230 EV ..TL0..RB110230 EV ..TL0..RG110230 EV ..TL0..RR110230 EV ..TL0..RV110230				110+230 50+60Hz			EV ..TL0..RA12-24 EV ..TL0..RB12-24 EV ..TL0..RG12-24 EV ..TL0..RR12-24 EV ..TL0..RV12-24	12-24-48	blu- blue bianco - white giallo - yellow rosso - red verde - green	luce rotante rotating light	EVA 50 EVA 125 EVA 125 EVA 125 EVA 125	60 led 80 led 100 led 120 led 180 led	5+6 6+7 7+8 8+9 12+15

	Codice Code	[Vac]	Codice Code	[Vac/dc]	Xenon Xenon	Colore Color	Funzione Function	EVA EVA	[W]				
	XENON FLASH	EV 50LAX110+230 EV 50LBX110+230 EV 50LGX110+230 EV 50LRX110+230 EV 50LVX110-230	110-230 50+60Hz	EV 50LAX12-24 EV 50LBX12-24 EV 50LGX12-24 EV 50LRX12-24 EV 50LVX12-24	12-24-48	6 JOULE	blu- blue giallo - yellow rosso - red verde - green	luce lamp. flashing light	EVA 50	10			
EV 125L16AX110+230 EV 125L16BX110+230 EV 125L16GX110+230 EV 125L16RX110+230 EV 125L16VX110+230		110-230 50+60Hz		EV 125L16AX12-24 EV 125L16BX12-24 EV 125L16GX12-24 EV 125L16RX12-24 EV 125L16VX12-24		12-24-48	16 JOULE	blu- blue giallo - yellow rosso - red verde - green	luce lamp. flashing light	EVA 125	20		
EV 125L20AX110+230 EV 125L20BX110+230 EV 125L20GX110+230 EV 125L20RX110+230 EV 125L20VX110+230				110-230 50+60Hz			EV 125L20AX12-24 EV 125L20BX12-24 EV 125L20GX12-24 EV 125L20RX12-24 EV 125L20VX12-24	12-24-48	20 JOULE	blu- blue giallo - yellow rosso - red verde - green	luce lamp. flashing light	EVA 125	30

esempio : EV 80TL100RG24 : lampada tower led a N° 100 led 24Vac/dc luce gialla rotante
sample : EV 80TL100RG24 : tower led lamp with N° 100 led 24Vac/dc rotating yellow light

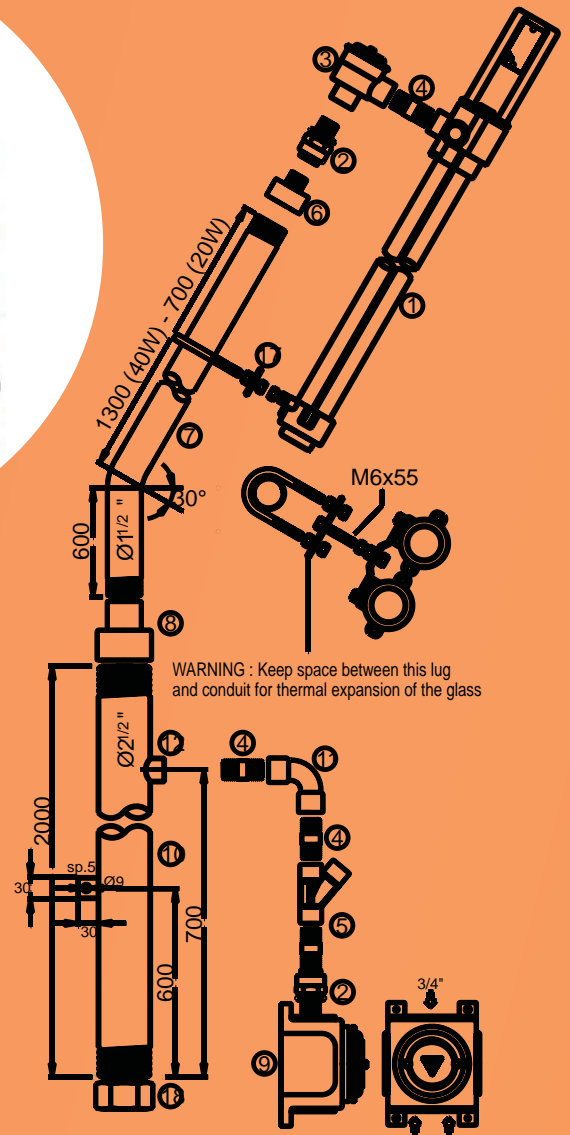
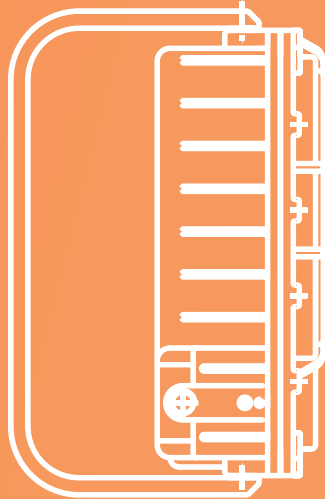
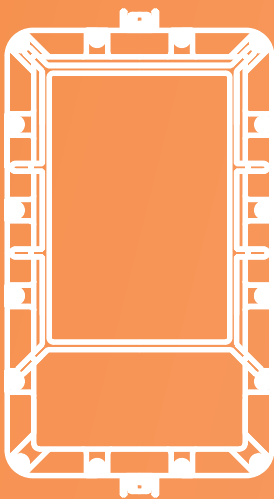
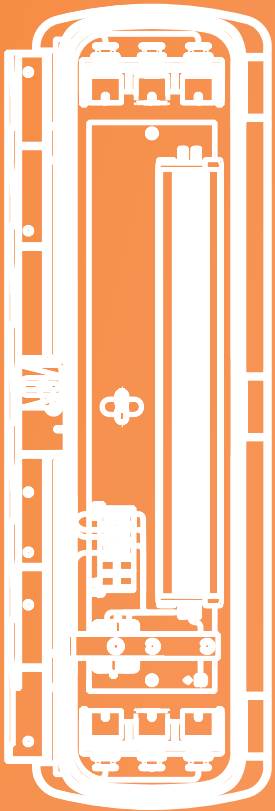
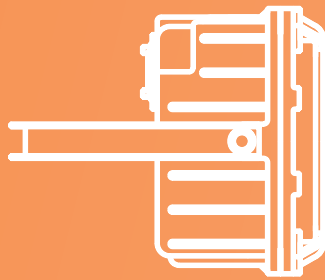
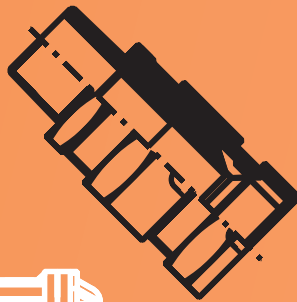
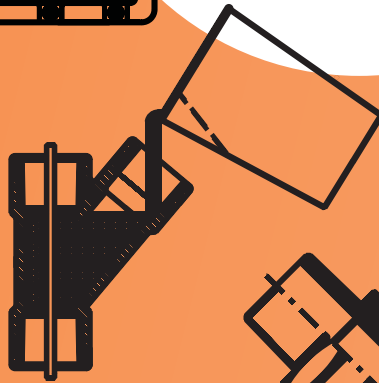
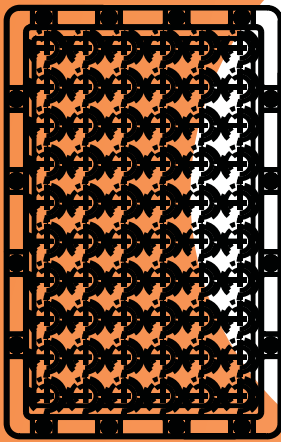
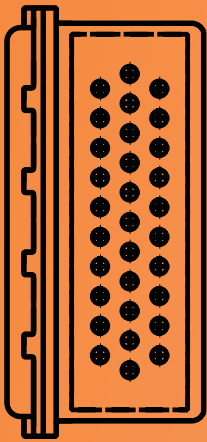

SOURCE IEC

19998 Hickory Twig Way
Spring, TX 77388 USA
Tel: +001 281 882 8300
Fax: +001 281 882 8305
sales@sourceiec.com
www.sourceiec.com